



## Raccorderia generale



**art. 228**

Prolunga in acciaio zincato.



cod. art.	mis.	€	conf.
00228.001	3/8"x10	<b>0,986</b>	100
00228.002	3/8"x15	<b>1,068</b>	100
00228.003	3/8"x20	<b>1,238</b>	100
00228.004	3/8"x25	<b>1,710</b>	100
00228.005	3/8"x30	<b>1,848</b>	100
00228.006	3/8"x40	<b>3,613</b>	100
00228.007	3/8"x50	<b>4,118</b>	100
00228.008	1/2"x10	<b>0,871</b>	100
00228.009	1/2"x15	<b>0,931</b>	100
00228.010	1/2"x20	<b>1,114</b>	100
00228.011	1/2"x25	<b>1,550</b>	100
00228.012	1/2"x30	<b>1,765</b>	100
00228.013	1/2"x40	<b>3,531</b>	100
00228.014	1/2"x50	<b>4,012</b>	100
00228.015	3/4"x10	<b>1,940</b>	100
00228.016	3/4"x15	<b>2,146</b>	100
00228.017	3/4"x20	<b>2,375</b>	100
00228.018	3/4"x25	<b>3,338</b>	100
00228.019	3/4"x30	<b>3,622</b>	100
00228.020	3/4"x40	<b>6,066</b>	50
00228.021	3/4"x50	<b>6,832</b>	50
00228.023	1"x15	<b>5,103</b>	100
00228.024	1"x20	<b>6,066</b>	100
00228.025	1"x25	<b>7,190</b>	100
00228.026	1"x30	<b>7,901</b>	100
00228.027	1"x40	<b>9,904</b>	100
00228.028	1"x50	<b>10,798</b>	100

**art. 229**

Manicotto ridotto F.F. zincato.



00229.001	3/8"x1/4"	<b>2,008</b>	100
00229.002	1/2"x3/8"	<b>2,604</b>	100
00229.003	3/4"x1/2"	<b>3,338</b>	100
00229.004	1"x1/2"	<b>6,112</b>	100
00229.005	1"x3/4"	<b>5,654</b>	100
00229.054	3/4"x3/8"	<b>4,274</b>	100
00229.012	1/2"x1/4"	<b>3,095</b>	100

**art. 230**

Manicotto ridotto M.F. (prolunga ridotta) zincato.



00230.001	3/8"x1/4"	<b>1,802</b>	100
00230.002	1/2"x3/8"	<b>1,536</b>	100
00230.003	3/4"x3/8"	<b>3,430</b>	100
00230.004	3/4"x1/2"	<b>2,568</b>	100
00230.005	1/2"x1"	<b>6,502</b>	100
00230.006	3/4"x1"	<b>4,448</b>	100

**art. 232**

Niples tutto filetto in acciaio zincato.



00232.001	3/8"x1/2"	<b>2,467</b>	100
00232.002	1/2"x3/4"	<b>3,485</b>	100
00232.003	3/4"x1"	<b>5,654</b>	100

**art. 231N**

Manicotto in acciaio nero.

**art. 231Z**

Idem zincato.

cod. art.	mis.	€	conf.
0231N.001	1/8"	<b>2,105</b>	100
0231N.002	1/4"	<b>1,692</b>	100
0231N.003	3/8"	<b>2,228</b>	100
0231N.004	1/2"	<b>2,371</b>	100
0231N.005	3/4"	<b>2,930</b>	100
0231N.006	1"	<b>4,539</b>	100
0231N.007	1"1/4	<b>6,603</b>	50
0231N.008	1"1/2	<b>8,148</b>	50
0231N.009	2"	<b>11,101</b>	50
0231N.010	2"1/2	<b>17,557</b>	10
0231N.011	3"	<b>24,986</b>	5
0231N.012	4"	<b>43,951</b>	5
0231Z.001	1/8"	<b>1,697</b>	100
0231Z.002	1/4"	<b>1,504</b>	100
0231Z.003	3/8"	<b>1,504</b>	100
0231Z.004	1/2"	<b>1,697</b>	100
0231Z.005	3/4"	<b>2,215</b>	100
0231Z.006	1"	<b>3,301</b>	100
0231Z.007	1"1/4	<b>5,195</b>	50
0231Z.008	1"1/2	<b>6,410</b>	50
0231Z.009	2"	<b>8,827</b>	50
0231Z.010	2"1/2	<b>13,848</b>	10
0231Z.011	3"	<b>19,579</b>	5
0231Z.012	4"	<b>38,265</b>	5
0231Z.013	5"	<b>95,100</b>	5
0231Z.014	6"	<b>174,518</b>	5

**art. 231MN**

Mezzi manicotti FF acciaio nero.



231MN.001	1/4"	<b>2,082</b>	100
231MN.002	3/8"	<b>2,105</b>	100
231MN.003	1/2"	<b>2,105</b>	100
231MN.004	3/4"	<b>2,907</b>	100
231MN.005	1"	<b>4,186</b>	100
231MN.006	1"1/4	<b>6,539</b>	100
231MN.007	1"1/2	<b>7,841</b>	100
231MN.008	2"	<b>10,358</b>	100

**art. 233**

Niples tutto filetto in acciaio zincato.



00233.001	3/8"	<b>1,261</b>	100
00233.002	1/2"	<b>1,307</b>	100
00233.003	3/4"	<b>2,146</b>	100
00233.004	1"	<b>3,361</b>	100
00233.005	1"1/4	<b>6,961</b>	50
00233.006	1"1/2	<b>8,391</b>	50
00233.007	2"	<b>12,289</b>	50

**art. 234**

Tappo esagonale M. zincato.



00234.002	1/4"	<b>0,940</b>	50
00234.003	3/8"	<b>0,940</b>	50
00234.004	1/2"	<b>1,023</b>	50
00234.005	3/4"	<b>1,642</b>	50
00234.006	1"	<b>3,852</b>	50

**art. 234Q**

Tappo maschio zincato con quadro.



cod. art.	mis.	€	conf.
0234Q.001	1/8"	1,091	100
0234Q.002	1/4"	1,091	100
0234Q.003	3/8"	1,160	100
0234Q.004	1/2"	1,206	100
0234Q.005	3/4"	1,825	100
0234Q.006	1"	2,925	100

**art. 235**

Riduzione esagonale zincata M.F.



00235.001	1/4"x1/8"	1,605	100
00235.002	3/8"x1/4"	1,146	100
00235.003	1/2"x1/4"	1,353	100
00235.004	1/2"x3/8"	1,252	100
00235.005	3/4"x3/8"	1,848	100
00235.006	3/4"x1/2"	1,779	100
00235.007	1"x1/2"	3,943	100
00235.008	1"x3/4"	3,691	100

**art. 236**

Vite doppia ridotta zincata.



00236.001	1/4"x1/8"	2,077	100
00236.002	3/8"x1/4"	1,435	100
00236.003	1/2"x1/4"	2,123	100
00236.004	1/2"x3/8"	1,619	100
00236.005	3/4"x3/8"	3,210	100
00236.006	3/4"x1/2"	2,925	100
00236.007	1"x1/2"	5,562	100
00236.008	1"x3/4"	5,379	100

**art. 237**

Vite doppia esagonale zincata.



00237.001	1/8"	2,132	100
00237.002	1/4"	1,275	100
00237.003	3/8"	1,353	100
00237.004	1/2"	1,596	100
00237.005	3/4"	2,077	100
00237.006	1"	4,471	100

**art. 238**

Controdado in acciaio zincato.



00238.001	1/8"	1,917	100
00238.002	1/4"	1,399	100
00238.003	3/8"	1,880	100
00238.004	1/2"	2,971	100
00238.005	3/4"	4,072	100
00238.006	1"	6,511	100

**art. 239**

Tappo femmina in acciaio zincato.



00239.001	1/4"	1,674	100
00239.002	3/8"	1,192	100
00239.003	1/2"	1,252	100
00239.004	3/4"	1,742	100
00239.005	1"	6,419	100

**art. 240**

Barilotto in acciaio zincato.

**N.B. ALTRE MISURE A RICHIESTA**

cod. art.	mis.	€	conf.
00240.001	3/8"x60	1,245	10
00240.002	3/8"x80	1,512	10
00240.003	3/8"x100	1,734	10
00240.004	3/8"x120	2,045	10
00240.005	3/8"x150	2,401	10
00240.006	3/8"x200	3,068	10
00240.007	3/8"x250	3,779	10
00240.008	3/8"x300	4,446	10
00240.009	1/2"x60	1,245	10
00240.010	1/2"x80	1,512	10
00240.011	1/2"x100	1,734	10
00240.012	1/2"x120	2,045	10
00240.013	1/2"x150	2,401	10
00240.014	1/2"x200	3,068	10
00240.015	1/2"x250	3,779	10
00240.016	1/2"x300	4,446	10
00240.072	1/2"x500	7,025	1
00240.073	1/2"x800	11,116	1
00240.074	1/2"x1000	12,717	1
00240.017	3/4"x60	1,512	10
00240.018	3/4"x80	1,823	10
00240.019	3/4"x100	2,179	10
00240.020	3/4"x120	2,490	10
00240.021	3/4"x150	2,979	10
00240.022	3/4"x200	3,868	10
00240.023	3/4"x250	4,713	10
00240.024	3/4"x300	5,602	10
00240.075	3/4"x500	8,670	1
00240.076	3/4"x800	13,962	1
00240.077	3/4"x1000	16,052	1
00240.025	1"x60	2,134	10
00240.026	1"x80	2,534	10
00240.027	1"x100	3,024	10
00240.028	1"x120	3,557	10
00240.029	1"x150	4,224	10
00240.030	1"x200	5,469	10
00240.031	1"x250	6,136	10
00240.032	1"x300	7,292	10
00240.078	1"x500	12,672	1
00240.079	1"x800	20,542	1
00240.080	1"x1000	23,744	1
00240.033	1"1/4x80	3,379	10
00240.034	1"1/4x100	4,002	10
00240.035	1"1/4x120	4,713	10
00240.036	1"1/4x150	5,514	10
00240.037	1"1/4x200	6,892	10
00240.038	1"1/4x250	8,404	10
00240.039	1"1/4x300	10,049	10
00240.081	1"1/4x500	15,918	1
00240.082	1"1/4x800	26,100	1
00240.083	1"1/4x1000	30,280	1
00240.040	1"1/2x80	3,913	10
00240.041	1"1/2x100	4,624	10
00240.042	1"1/2x120	5,425	10
00240.043	1"1/2x150	6,269	10
00240.044	1"1/2x200	7,559	10
00240.045	1"1/2x250	9,204	10
00240.046	1"1/2x300	10,983	10
00240.084	1"1/2x500	18,008	1
00240.085	1"1/2x800	29,640	1
00240.086	1"1/2x1000	34,326	1
00240.047	2"x80	5,469	10
00240.048	2"x100	6,447	10
00240.049	2"x120	7,559	10
00240.050	2"x150	8,626	10
00240.051	2"x200	10,360	10

## art. 240

Barilotto in acciaio zincato.



cod. art.	mis.	€	conf.
00240.052	2"x250	<b>12,806</b>	10
00240.053	2"x300	<b>15,251</b>	10
00240.087	2"x500	<b>24,855</b>	1
00240.088	2"x800	<b>40,862</b>	1
00240.089	2"x1000	<b>47,087</b>	1
00240.054	2"1/2x100	<b>10,093</b>	10
00240.055	2"1/2x120	<b>11,160</b>	10
00240.056	2"1/2x150	<b>12,850</b>	10
00240.057	2"1/2x200	<b>15,963</b>	10
00240.058	2"1/2x250	<b>18,986</b>	10
00240.059	2"1/2x300	<b>21,921</b>	10
00240.060	3"x100	<b>13,072</b>	10
00240.061	3"x120	<b>14,495</b>	10
00240.062	3"x150	<b>16,674</b>	10
00240.063	3"x200	<b>20,720</b>	10
00240.064	3"x250	<b>24,233</b>	10
00240.065	3"x300	<b>28,324</b>	10
00240.066	4"x100	<b>19,520</b>	10
00240.067	4"x120	<b>21,832</b>	10
00240.068	4"x150	<b>26,189</b>	10
00240.069	4"x200	<b>32,325</b>	10
00240.070	4"x250	<b>38,639</b>	10
00240.071	4"x300	<b>44,953</b>	10

## art. 240A

Scorrevole zincato.



0240A.001	3/8"x100	<b>2,312</b>	10
0240A.002	1/2"x100	<b>2,312</b>	10
0240A.003	3/4"x120	<b>3,379</b>	10
0240A.004	1"x150	<b>5,380</b>	10
0240A.005	1"1/4x150	<b>6,581</b>	10
0240A.006	1"1/2x150	<b>7,381</b>	10
0240A.007	2"X150	<b>9,782</b>	10

**art. 8706**

Kit estrattori per raccordi filettati,  
composto da:

- 1 maschio 3/8"
- 1 estrattore 3/8"
- 1 maschio 1/2"
- 1 estrattore 1/2"
- chiave a cricchetto

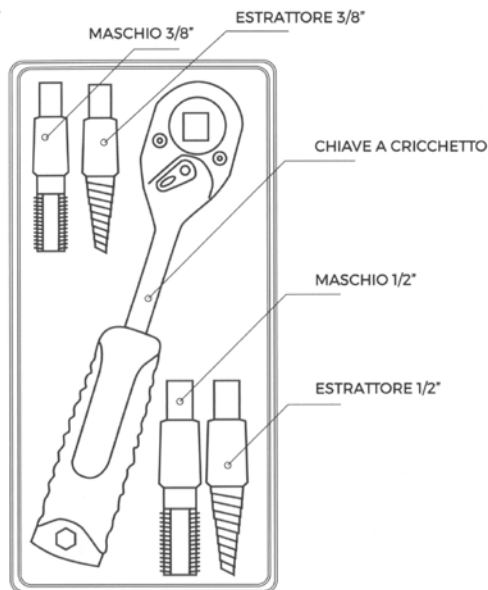

cod. art.	mis.	€	conf.
08706.000		123,231	1

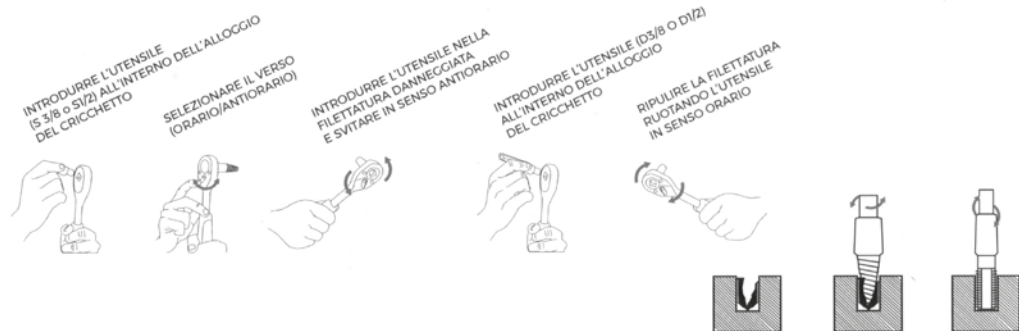
**10**
**art. 699CF**

Tubo forato con filtro e puntale.

**art. 699SF**

Tubo forato senza filtro con puntale.



699CF.112	1"1/2	574,419	1
699CF.200	2"	662,792	1
699CF.212	2"1/2	1060,466	1
699CF.300	3"	1148,839	1
699CF.400	4"	1767,444	1
699SF.112	1"1/2	355,698	1
699SF.200	2"	399,884	1
699SF.212	2"1/2	638,489	1
699SF.300	3"	821,861	1
699SF.400	4"	1016,280	1

**art. 699TP**

Tubo da pozzo zincato da mt. 2.

Peso circa per barra da mt. 2

- 1"1/4 = 10 Kg
- 1"1/2 = 11 Kg
- 2" = 15 Kg
- 2"1/2 = 20 Kg
- 3" = 25 Kg
- 4" = 37 Kg



699TP.114	1"1/4	10,421 / Kg
699TP.112	1"1/2	10,421 / Kg
699TP.200	2"	10,421 / Kg
699TP.212	2"1/2	10,421 / Kg
699TP.300	3"	12,506 / Kg
699TP.400	4"	12,506 / Kg

### art. 699PU

Puntale tornito.



cod. art.	mis.	€	conf.
699PU.112	1"1/2 filettato	75,116	1
699PU.200	2" filettato	81,744	1
699PU.310	3" a saldare	185,582	1
699PU.400	4" a saldare	287,210	1

### art. 699MO

Manicotto a oliva.



699MO.114	1"1/4	28,721	2
699MO.112	1"1/2	30,930	2
699MO.200	2"	33,140	2
699MO.212	2"1/2	55,233	2
699MO.300	3"	75,116	2
699MO.400	4"	130,349	2

### art. 8540N

Curve a saldare dima 3D 90° ricavate da tubo saldato EN 10253 - 1 (DIN 2605) R. St. 37.0.W



	D	Ø	S mm		
8540N.002	3/4"	26,9	2,3	4,180	10
8540N.003	1"	33,7	2,6	3,321	10
8540N.004	1"1/4	42,4	2,6	4,202	10
8540N.005	1"1/2	48,3	2,6	5,082	10
8540N.006	2"	60,3	2,9	8,221	10
8540N.007	2"1/2	76,1	2,3	13,166	10
8540N.008	3"	88,9	3,2	22,588	10
8540N.009	4"	114,3	3,6	42,877	10
8540N.010	5"	139,7	4,0	61,347	10
8540N.011	6"	168,3	4,5	99,284	10
8540N.012	8"	219,1	6,3	224,139	10
8540N.013	10"	273	6,3	479,771	10
8540N.014	12"	323,9	7,1	719,276	10

### art. 8535N

Riduzioni concentriche ricavate da tubo senza saldatura EN10253 - 1 (DIN 2616) R. St. 35.8/I)



8535N.003	33,7x26,9	1"x3/4	9,422	10
8535N.004	42,4x26,9	1"1/4x3/4	10,565	10
8535N.005	42,4x33,7	1"1/4x1	9,662	10
8535N.006	48,3x26,9	1"1/2x3/4	14,584	10
8535N.007	48,3x33,7	1"1/2x1"	11,463	10
8535N.008	48,3x42,4	1"1/2x1"1/4	10,565	10
8535N.010	60,3x33,7	2x1"	15,184	10
8535N.011	60,3x42,4	2x1"1/4	14,286	10
8535N.012	60,3x48,3	2x1"1/2	11,583	10
8535N.014	76,1x42,4	2"1/2x1"1/4	18,786	10
8535N.015	76,1x48,3	2"1/2x1"1/2	17,105	10
8535N.016	76,1x60,3	2"1/2x2	15,305	10
8535N.017	88,9x42,4	3"x1"1/4	33,913	10
8535N.018	88,9x48,3	3"x1"1/2	26,172	10
8535N.019	88,9x60,3	3x2	21,129	10
8535N.020	88,9x76,1	3"x2"1/2	17,768	10
8535N.022	114,3x60,3	4x2	43,699	10
8535N.023	114,3x76,1	4"x2"1/2	34,393	10
8535N.024	114,3x88,9	4x3	30,671	10
8535N.026	139,7x76,1	5"x2"1/2	a richiesta	10
8535N.027	139,7x88,9	5x3	a richiesta	10
8535N.028	139,7x114,3	5x4	a richiesta	10
8535N.030	168,3x88,9	6x3	a richiesta	10
8535N.031	168,3x114,3	6x4	a richiesta	10
8535N.032	168,3x139,7	6x5	a richiesta	10
8535N.035	219,1x168,3	8x3	a richiesta	10
8535N.036	273x139,7	10x5	a richiesta	10
8535N.038	273x219,1	10x8	a richiesta	10
8535N.040	323,9x219,1	12x8	a richiesta	10
8535N.041	323,9x273	12x10	a richiesta	10



**art. 8537N**

Tee normali



cod. art.	mis.		€	conf.
	D	Ø mm		
8537N.001	1/2"	21,3	21,067	1
8537N.002	3/4"	26,9	21,947	1
8537N.003	1"	33,7	25,309	1
8537N.004	1"1/4	42,4	28,493	1
8537N.005	1"1/2	48,3	33,815	1
8537N.006	2"	60,3	42,299	1
8537N.007	2"1/2	76,1	66,727	1
8537N.008	3"	88,9	93,979	1
8537N.009	4"	114,3	132,658	1
8537N.010	5"	139,7	185,802	1
8537N.011	6"	168,3	274,098	1
8537N.012	8"	219,1	a richiesta	1
8537N.013	10"	273	a richiesta	1
8537N.014	12"	323,9	a richiesta	1

**art. 700**

 Fondelli bombati  
 DIN 28011 St.W 24

	D	Ø mm		
00700.002	1"	33,7	a richiesta	1
00700.003	1"1/4	42,4	a richiesta	1
00700.004	1"1/2	48,3	a richiesta	1
00700.005	2"	60,3	a richiesta	1
00700.006	2"1/2	76,1	a richiesta	1
00700.007	3"	88,9	a richiesta	1
00700.008	3"1/2	101,6	a richiesta	1
00700.009	3"1/2	108	a richiesta	1
00700.010	4"	114,3	a richiesta	1
00700.011	4"	133	a richiesta	1
00700.012	5"	139,7	a richiesta	1
00700.013	5"	159	a richiesta	1
00700.014	6"	168,3	a richiesta	1
00700.015	6"	194	a richiesta	1
00700.016	8"	219	a richiesta	1
00700.017	8"	244	a richiesta	1
00700.018	10"	273	a richiesta	1
00700.019	12"	324	a richiesta	1

**art. 8545N**

 Tronchetto nero  
 DIN 2982 R. St. 37.0

8545N.001	3/8"	100	1,512	10
8545N.002	1/2"	100	1,512	10
8545N.003	3/4"	100	1,748	10
8545N.004	1"	100	2,409	10
8545N.005	1"1/4	100	3,307	10
8545N.006	1"1/2	100	3,827	10
8545N.007	2"	100	5,149	10
8545N.008	2"1/2	100	7,464	10
8545N.009	3"	100	9,685	10
8545N.010	4"	100	14,126	10
8545N.011	3/8"	150	1,984	10
8545N.012	1/2"	150	1,984	10
8545N.013	3/4"	150	2,362	10
8545N.014	1"	150	3,307	10
8545N.015	1"1/4	150	4,488	10
8545N.016	1"1/2	150	5,149	10
8545N.017	2"	150	7,039	10
8545N.018	2"1/2	150	9,827	10
8545N.019	3"	150	12,756	10
8545N.020	4"	150	19,464	10
8545N.021	3/8"	200	2,551	10
8545N.022	1/2"	200	2,551	10

art. **8545N**  
Tronchetto nero  
DIN 2982 R. St. 37.0



cod. art.	mis.		€	conf.
8545N.023	3/4"	200	3,024	10
8545N.024	1"	200	4,205	10
8545N.025	1"1/4	200	5,575	10
8545N.026	1"1/2	200	6,425	10
8545N.027	2"	200	8,787	10
8545N.028	2"1/2	200	12,236	10
8545N.029	3"	200	15,921	10
8545N.030	4"	200	24,425	10
8545N.031	3/8"	250	3,118	10
8545N.032	1/2"	250	3,118	10
8545N.033	3/4"	250	3,638	10
8545N.034	1"	250	5,102	10
8545N.035	1"1/4	250	6,756	10
8545N.036	1"1/2	250	7,701	10
8545N.037	2"	250	10,771	10
8545N.038	2"1/2	250	15,023	10
8545N.039	3"	250	19,370	10
8545N.040	4"	250	30,141	10
8545N.041	3/8"	300	3,638	10
8545N.042	1/2"	300	3,638	10
8545N.043	3/4"	300	4,299	10
8545N.044	1"	300	6,094	10
8545N.045	1"1/4	300	8,031	10
8545N.046	1"1/2	300	9,212	10
8545N.047	2"	300	12,803	10
8545N.048	2"1/2	300	17,669	10
8545N.049	3"	300	22,818	10
8545N.050	4"	300	35,574	10

art. **8550N**  
Flange in ferro piano PN 10/16  
UNI 2277/2278, EN 1092-1/11



8550N.001	1"	25 4 fori	a richiesta	10
8550N.002	1"1/4	32 4 fori	a richiesta	10
8550N.003	1"1/2	40 4 fori	a richiesta	10
8550N.004	2"	50 4 fori	a richiesta	10
8550N.005	2"1/2	65 8 fori	a richiesta	10
8550N.006	3"	80 8 fori	a richiesta	10
8550N.007	4"	100 8 fori	a richiesta	10
8550N.008	5"	125 8 fori	a richiesta	10
8550N.009	6"	150 8 fori	a richiesta	10
8550N.010	8"	200 8 fori	a richiesta	10

art. **8552N**  
Flange in ferro a collarino PN 10/16  
UNI 2281/2282, EN 1092-1/11



8552N.001	1"	25 4 fori	a richiesta	10
8552N.002	1"1/4	32 4 fori	a richiesta	10
8552N.003	1"1/2	40 4 fori	a richiesta	10
8552N.004	2"	50 4 fori	a richiesta	10
8552N.005	2"1/2	65 8 fori	a richiesta	10
8552N.006	3"	80 8 fori	a richiesta	10
8552N.007	4"	100 8 fori	a richiesta	10
8552N.008	5"	125 8 fori	a richiesta	10
8552N.009	6"	150 8 fori	a richiesta	10
8552N.010	8"	200 8 fori	a richiesta	10

art. **8554N**  
Flange in ferro filettate a collarino  
PN 10/16 UNI 2254, EN 1092-1/13  
Zincate



8554N.001	1"	25 4 fori	a richiesta	10
8554N.002	1"1/4	32 4 fori	a richiesta	10
8554N.003	1"1/2	40 4 fori	a richiesta	10
8554N.004	2"	50 4 fori	a richiesta	10
8554N.005	2"1/2	65 8 fori	a richiesta	10
8554N.006	3"	80 8 fori	a richiesta	10
8554N.007	4"	100 8 fori	a richiesta	10
8554N.008	5"	125 8 fori	a richiesta	10
8554N.009	6"	150 8 fori	a richiesta	10

**art. 8555N**

Bulloni per flange



cod. art.	mis.	€	conf.
<b>8555N.001</b>	Ø 12x50 per fl. 32-50	<b>1,479</b>	10
<b>8555N.002</b>	Ø 16x65 oltre	<b>3,269</b>	10

**art. 887ES**

 Guarnizioni per flange PN 10 - PN 16  
 esente amianto spessore mm 2 a norma

<b>887ES.001</b>	DN 15 50x22	<b>0,375</b>	10
<b>887ES.002</b>	DN 20 61x27	<b>0,521</b>	10
<b>887ES.003</b>	DN 25 70x34	<b>0,653</b>	10
<b>887ES.004</b>	DN 32 82x42	<b>0,764</b>	10
<b>887ES.005</b>	DN 40 98x47	<b>0,987</b>	10
<b>887ES.006</b>	DN 50 107x59	<b>1,390</b>	10
<b>887ES.007</b>	DN 65 127x76	<b>1,924</b>	10
<b>887ES.008</b>	DN 80 142x89	<b>2,286</b>	10
<b>887ES.009</b>	DN 100 163x117	<b>2,598</b>	10
<b>887ES.010</b>	DN 125 192x133	<b>3,675</b>	10
<b>887ES.011</b>	DN 150 218x168	<b>4,231</b>	10
<b>887ES.012</b>	DN 175 248x195	<b>5,398</b>	10
<b>887ES.013</b>	DN 200 274x220	<b>7,760</b>	10
<b>887ES.014</b>	DN 250 320x275	<b>9,178</b>	10
<b>887ES.015</b>	DN 300 280x325	<b>12,089</b>	10

**art. 887A**

 Guarnizioni per flange in gomma tela  
 spessore mm 3

<b>0887A.001</b>	DN 15 50x22	<b>0,361</b>	10
<b>0887A.002</b>	DN 20 61,27	<b>0,431</b>	10
<b>0887A.003</b>	DN 25 40x34	<b>0,521</b>	10
<b>0887A.004</b>	DN 32 82x42	<b>0,674</b>	10
<b>0887A.005</b>	DN 40 98x47	<b>0,764</b>	10
<b>0887A.006</b>	DN 50 107x59	<b>0,917</b>	10
<b>0887A.007</b>	DN 65 127x76	<b>1,244</b>	10
<b>0887A.008</b>	DN 50 142x89	<b>1,744</b>	10
<b>0887A.009</b>	DN 100 163x117	<b>2,216</b>	10
<b>0887A.010</b>	DN 125 192x133	<b>2,932</b>	10
<b>0887A.011</b>	DN 150 210x168	<b>3,154</b>	10
<b>0887A.012</b>	DN 175 248x195	<b>6,690</b>	10
<b>0887A.013</b>	DN 200 274x220	<b>5,586</b>	10
<b>0887A.014</b>	DN 250 320x275	<b>8,094</b>	10
<b>0887A.015</b>	DN 300 380x325	<b>13,826</b>	10

## RACCORDERIA IN ACCIAIO INOX

**art. 8600**

Gomito F.F. AISI 316



<b>08600.001</b>	Ø 1/8"	<b>2,851</b>	10
<b>08600.002</b>	Ø 1/4"	<b>3,051</b>	10
<b>08600.003</b>	Ø 3/8"	<b>3,902</b>	10
<b>08600.004</b>	Ø 1/2"	<b>4,952</b>	10
<b>08600.005</b>	Ø 3/4"	<b>7,003</b>	10
<b>08600.006</b>	Ø 1"	<b>11,255</b>	10
<b>08600.007</b>	Ø 1"1/4	<b>17,758</b>	10
<b>08600.008</b>	Ø 1"1/2	<b>21,409</b>	10
<b>08600.009</b>	Ø 2"	<b>34,765</b>	10
<b>08600.010</b>	Ø 2"1/2	<b>70,031</b>	10
<b>08600.011</b>	Ø 3"	<b>96,542</b>	10

**art. 8602**

Gomito M.F. AISI 316



<b>08602.001</b>	Ø 1/8"	<b>3,602</b>	10
<b>08602.002</b>	Ø 1/4"	<b>3,902</b>	10
<b>08602.003</b>	Ø 3/8"	<b>4,202</b>	10
<b>08602.004</b>	Ø 1/2"	<b>5,402</b>	10
<b>08602.005</b>	Ø 3/4"	<b>7,603</b>	10
<b>08602.006</b>	Ø 1"	<b>12,005</b>	10
<b>08602.007</b>	Ø 1"1/4	<b>18,408</b>	10
<b>08602.008</b>	Ø 1"1/2	<b>24,011</b>	10
<b>08602.009</b>	Ø 2"	<b>37,517</b>	10
<b>08602.010</b>	Ø 2"1/2	<b>75,033</b>	10
<b>08602.011</b>	Ø 3"	<b>120,053</b>	10

**art. 8604**

Bocchettone conico curvo F.F. AISI 316



cod. art.	mis.	€	conf.
08604.001	Ø 1/2"	16,507	10
08604.002	Ø 3/4"	20,009	10
08604.003	Ø 1"	30,764	10
08604.004	Ø 1"1/4	55,024	10
08604.005	Ø 1"1/2	60,026	10
08604.006	Ø 2"	94,041	10

**art. 8606**

Bocchettone conico curvo M.F. AISI 316



08606.001	Ø 1/2"	18,008	10
08606.002	Ø 3/4"	22,510	10
08606.003	Ø 1"	35,015	10
08606.004	Ø 1"1/4	57,525	10
08606.005	Ø 1"1/2	65,029	10
08606.006	Ø 2"	102,545	10

**art. 8608**

Tee AISI 316



08608.001	Ø 1/8"	3,652	10
08608.002	Ø 1/4"	4,102	10
08608.003	Ø 3/8"	5,052	10
08608.004	Ø 1/2"	6,703	10
08608.005	Ø 3/4"	9,254	10
08608.006	Ø 1"	14,506	10
08608.007	Ø 1"1/4	22,360	10
08608.008	Ø 1"1/2	26,512	10
08608.009	Ø 2"	42,919	10
08608.010	Ø 2"1/2	86,038	10
08608.011	Ø 3"	128,056	10

**art. 8610**

Croce AISI 316



08610.001	Ø 1/4"	5,753	10
08610.002	Ø 3/8"	7,503	10
08610.003	Ø 1/2"	10,004	10
08610.004	Ø 3/4"	16,507	10
08610.005	Ø 1"	22,510	10
08610.006	Ø 1"1/4	34,515	10
08610.007	Ø 1"1/2	44,019	10
08610.008	Ø 2"	63,528	10

**art. 8612**

Nipplo AISI 316



08612.001	Ø 1/8"	2,751	10
08612.002	Ø 1/4"	2,751	10
08612.003	Ø 3/8"	2,851	10
08612.004	Ø 1/2"	3,927	10
08612.005	Ø 3/4"	4,902	10
08612.006	Ø 1"	7,353	10
08612.007	Ø 1"1/4	11,505	10
08612.008	Ø 1"1/2	13,856	10
08612.009	Ø 2"	20,759	10
08612.010	Ø 2"1/2	36,766	10
08612.011	Ø 3"	55,024	10

**art. 8614**

Tappo M AISI 316



08614.001	Ø 1/8"	2,501	10
08614.002	Ø 1/4"	2,601	10
08614.003	Ø 3/8"	2,901	10
08614.004	Ø 1/2"	3,051	10
08614.005	Ø 3/4"	4,002	10
08614.006	Ø 1"	6,253	10
08614.007	Ø 1"1/4	10,505	10
08614.008	Ø 1"1/2	12,255	10
08614.009	Ø 2"	19,008	10
08614.010	Ø 2"1/2	30,013	10
08614.011	Ø 3"	42,519	10

art. **8616**  
Tappo F AISI 316



cod. art.	mis.	€	conf.
08616.001	Ø 1/8"	2,751	10
08616.002	Ø 1/4"	2,851	10
08616.003	Ø 3/8"	2,951	10
08616.004	Ø 1/2"	3,401	10
08616.005	Ø 3/4"	4,802	10
08616.006	Ø 1"	7,803	10
08616.007	Ø 1"1/4	10,755	10
08616.008	Ø 1"1/2	14,006	10
08616.009	Ø 2"	21,760	10
08616.010	Ø 2"1/2	34,265	10
08616.011	Ø 3"	49,772	10

art. **8618**  
Bocchettone conico F.F. diritto



08618.001	Ø 1/8"	8,504	10
08618.002	Ø 1/4"	9,254	10
08618.003	Ø 3/8"	9,604	10
08618.004	Ø 1/2"	11,255	10
08618.005	Ø 3/4"	15,007	10
08618.006	Ø 1"	22,510	10
08618.007	Ø 1"1/4	30,513	10
08618.008	Ø 1"1/2	40,018	10
08618.009	Ø 2"	55,024	10
08618.010	Ø 2"1/2	85,538	10
08618.011	Ø 3"	120,053	10

art. **8620**  
Bocchettone conico M.F. diritto



08620.002	Ø 1/4"	10,505	10
08620.003	Ø 3/8"	10,755	10
08620.004	Ø 1/2"	12,756	10
08620.005	Ø 3/4"	17,007	10
08620.006	Ø 1"	25,511	10
08620.007	Ø 1"1/4	36,266	10
08620.008	Ø 1"1/2	44,520	10
08620.009	Ø 2"	67,029	10
08620.010	Ø 2"1/2	120,053	10
08620.011	Ø 3"	160,070	10

art. **8622**  
Tuttavite AISI 316



08622.001	Ø 1/4"	a richiesta	10
08622.002	Ø 3/8"	a richiesta	10
08622.003	Ø 1/2"	a richiesta	10
08622.004	Ø 3/4"	a richiesta	10
08622.005	Ø 1"	a richiesta	10
08622.006	Ø 1"1/4	a richiesta	10
08622.007	Ø 1"1/2	a richiesta	10
08622.008	Ø 2"	a richiesta	10

art. **8624**  
Riduzione AISI 316



08624.001	Ø 1/4"x1/8"	2,801	10
08624.003	Ø 3/8"x1/4"	2,951	10
08624.005	Ø 1/2"x1/4"	3,151	10
08624.006	Ø 1/2"x3/8"	3,101	10
08624.008	Ø 3/4"x3/8"	4,302	10
08624.009	Ø 3/4"x1/2"	4,102	10
08624.010	Ø 1"x1/2"	7,103	10
08624.011	Ø 1"x3/4"	7,103	10
08624.014	Ø 1"1/4x1"	11,505	10

art. **8624**



cod. art.	mis.	€	conf.
08624.015	Ø 1"1/2x3/4"	16,007	10
08624.016	Ø 1"1/2x1"	15,007	10
08624.017	Ø 1"1/2x1"1/4	13,506	10
08624.018	Ø 2"x1"	24,011	10
08624.019	Ø 2"x1"1/4	23,510	10
08624.020	Ø 2"x1"1/2	21,509	10
08624.021	Ø 2"1/2x1"1/2	38,517	10
08624.022	Ø 2"1/2x2"	38,517	10
08624.023	Ø 3"x2"	51,523	10
08624.024	Ø 3"x2"1/2	47,021	10

art. **8626**

Vite doppia ridotta AISI 316



08626.001	Ø 1/4"x1/8"	2,901	10
08626.002	Ø 3/8"x1/4"	3,001	10
08626.004	Ø 1/2"x1/4"	3,652	10
08626.005	Ø 1/2"x3/8"	3,752	10
08626.007	Ø 3/4"x1/2"	5,402	10
08626.008	Ø 1"x1/2"	7,903	10
08626.009	Ø 1"x3/4"	8,254	10
08626.010	Ø 1"1/4x1"	12,506	10
08626.011	Ø 1"1/2x1"	14,756	10
08626.012	Ø 1"1/2x1"1/4	14,756	10
08626.013	Ø 2"x1"	22,010	10
08626.015	Ø 2"x1"1/2	22,260	10

art. **8628**

Controdado inox AISI 316



08628.001	Ø 1/8"	3,001	10
08628.002	Ø 1/4"	3,201	10
08628.003	Ø 3/8"	3,251	10
08628.004	Ø 1/2"	3,251	10
08628.005	Ø 3/4"	3,351	10
08628.006	Ø 1"	3,802	10
08628.007	Ø 1"1/4	5,252	10
08628.008	Ø 1"1/2	7,253	10
08628.009	Ø 2"	12,506	10

art. **8630**

Barilotto AISI 316



08630.001	Ø 1/4"	2,901	10
08630.002	Ø 3/8"	3,301	10
08630.003	Ø 1/2"	4,752	10
08630.004	Ø 3/4"	5,853	10
08630.005	Ø 1"	9,004	10
08630.006	Ø 1"1/4	12,506	10
08630.007	Ø 1"1/2	15,007	10
08630.008	Ø 2"	23,510	10

art. **8632**

Tronchetto a saldare AISI 316



08632.001	Ø 1/4"	2,001	10
08632.002	Ø 3/8"	2,151	10
08632.003	Ø 1/2"	2,901	10
08632.004	Ø 3/4"	3,652	10
08632.005	Ø 1"	5,002	10
08632.006	Ø 1"1/4	8,004	10
08632.007	Ø 1"1/2	9,254	10
08632.008	Ø 2"	12,005	10
08632.009	Ø 2"1/2	23,010	10
08632.010	Ø 3"	32,514	10

**art. 8634**

Manicotto a saldare AISI 316



cod. art.	mis.	€	conf.
08634.001	Ø 1/8"	2,451	10
08634.002	Ø 1/4"	3,051	10
08634.003	Ø 3/8"	3,502	10
08634.004	Ø 1/2"	4,202	10
08634.005	Ø 3/4"	5,052	10
08634.006	Ø 1"	7,853	10
08634.007	Ø 1"1/4	11,755	10
08634.008	Ø 1"1/2	12,756	10
08634.009	Ø 2"	25,011	10
08634.010	Ø 2"1/2	40,018	10
08634.011	Ø 3"	50,022	10
08634.012	Ø 4"	100,044	10

**art. 8636**

Mezzo manicotto a saldare AISI 316



08636.001	Ø 1/8"	a richiesta	10
08636.002	Ø 1/4"	a richiesta	10
08636.003	Ø 3/8"	a richiesta	10
08636.004	Ø 1/2"	a richiesta	10
08636.005	Ø 3/4"	a richiesta	10
08636.006	Ø 1"	a richiesta	10
08636.007	Ø 1"1/4	a richiesta	10
08636.008	Ø 1"1/2	a richiesta	10
08636.009	Ø 2"	a richiesta	10
08636.010	Ø 2"1/2	a richiesta	10

**art. 8638**

Portagomma M AISI 316



08638.001	Ø 1/4"x9	3,301	10
08638.002	Ø 3/8"x10	3,752	10
08638.003	Ø 1/2"x13,5	4,752	10
08638.004	Ø 3/4"x20	7,103	10
08638.005	Ø 1"x27	12,105	10
08638.006	Ø 1"1/4x33,5	17,258	10
08638.007	Ø 1"1/2x40	23,510	10
08638.009	Ø 2"x52	35,015	10

**art. 8645**

 Valvola a sfera Mini F. F. in AISI 316  
 Pressione (Temp. di utilizzo 20°C): 2/10 Bar  
 Temperatura: -40°C / +180°C  
 Leva: Alluminio

08645.001	Ø 3/8"	32,514	10
08645.002	Ø 1/2"	33,265	10
08645.003	Ø 3/4"	57,525	10

**A RICHIESTA ALTRE MISURE**
**art. 8646**

 Valvola a sfera Mini M. F. in AISI 316  
 Pressione (Temp. di utilizzo 20°C): 2/10 Bar  
 Temperatura: -40°C / +180°C  
 Leva: Alluminio

08646.001	Ø 3/8"	32,514	10
08646.002	Ø 1/2"	33,265	10
08646.003	Ø 3/4"	57,525	10

**A RICHIESTA ALTRE MISURE**
**art. 8640**

Valvola a sfera AISI 316



08640.001	Ø 1/4"	17,608	10
08640.002	Ø 3/8"	18,258	10
08640.003	Ø 1/2"	19,258	10
08640.004	Ø 3/4"	26,262	10
08640.005	Ø 1"	38,517	10
08640.006	Ø 1"1/4	60,527	10
08640.007	Ø 1"1/2	83,287	10
08640.008	Ø 2"	130,057	10
08640.009	Ø 2"1/2	270,119	10
08640.010	Ø 3"	375,165	10

**art. 8641**

 Rubinetto a sfera con portagomma  
 in AISI 316

08641.001	15	1/2"	a richiesta
08641.002	20	3/4"	a richiesta

### art. 8647

Rubinetto di erogazione a sfera con portagomma INOX AISI 316  
Leva: Accio Inox AISI 304



cod. art.	mis.	€	conf.
08647.000	Ø 1/2"	42,519	10

### art. 8642

Valvola di ritegno in acciaio inox AISI 304 stampata tenuta NBR, pressione nominale 16 BAR. Temperatura di esercizio -25°C +90°C.



08642.001	Ø 1/2"	56,025	10
08642.002	Ø 3/4"	69,519	10
08642.003	Ø 1"	81,636	10
08642.004	Ø 1"1/4	107,892	10
08642.005	Ø 1"1/2	133,970	10
08642.006	Ø 2"	245,864	10
08642.007	Ø 2"1/2	a richiesta	10
08642.008	Ø 3"	a richiesta	10
08642.009	Ø 4"	a richiesta	10

### art. 8644

Collare in acciaio inox AISI 304 con tassello



08644.001	Ø 1/2"	9,254	10
08644.002	Ø 3/4"	9,754	10
08644.003	Ø 1"	10,755	10
08644.004	Ø 1"1/4	11,505	10
08644.005	Ø 1"1/2	12,756	10
08644.006	Ø 2"	14,006	10
08644.007	Ø 2"1/2	24,261	10
08644.008	Ø 3"	25,761	10

### art. 8682

Riduzione concentrica AISI 304 spess. 2 mm



08682.001	Ø 26,9 x 21,3	10,004	10
08682.002	Ø 33,7 x 21,3	7,503	10
08682.003	Ø 33,7 x 26,9	7,253	10
08682.004	Ø 42,4 x 26,9	10,004	10
08682.005	Ø 42,4 x 33,7	9,754	10
08682.006	Ø 48,3 x 33,7	12,756	10
08682.007	Ø 48,3 x 42,4	12,255	10
08682.008	Ø 60,3 x 26,9	25,011	10
08682.009	Ø 60,3 x 33,7	15,007	10
08682.010	Ø 60,3 x 42,4	14,706	10
08682.011	Ø 60,3 x 48,3	14,006	10
08682.012	Ø 76,1 x 33,7	37,517	10
08682.013	Ø 76,1 x 42,4	25,011	10
08682.014	Ø 76,1 x 48,3	19,008	10
08682.015	Ø 76,1 x 60,3	17,508	10
08682.016	Ø 88,9 x 33,7	46,020	10
08682.017	Ø 88,9 x 42,4	35,015	10
08682.018	Ø 88,9 x 48,3	23,010	10
08682.019	Ø 88,9 x 60,3	21,009	10
08682.020	Ø 88,9 x 76,1	20,509	10
08682.021	Ø 114,3 x 48,3	35,015	10
08682.022	Ø 114,3 x 60,3	31,014	10
08682.023	Ø 114,3 x 76,1	30,764	10
08682.024	Ø 114,3 x 88,9	30,013	10



**art. 8680**

Curva a saldare mm 2 AISI 304



cod. art.	mis.	€	conf.
08680.001	21,3 x Ø 1/2"	<b>8,354</b>	10
08680.002	26,9 x Ø 3/4"	<b>9,104</b>	10
08680.003	33,7 x Ø 1"	<b>9,104</b>	10
08680.004	42,4 x Ø 1"1/4	<b>11,755</b>	10
08680.005	48,3 x Ø 1"1/2	<b>13,306</b>	10
08680.006	60,3 x Ø 2"	<b>18,908</b>	10
08680.007	76,1 x Ø 2"1/2	<b>33,015</b>	10
08680.008	88,9 x Ø 3"	<b>42,519</b>	10
08680.009	114,3 x Ø 4"	<b>70,031</b>	10

**art. 8684**

Fondello bombato AISI 304 spess. 2 mm



08684.001	21,3 1/2"	<b>3,001</b>	10
08684.002	26,9 3/4"	<b>3,101</b>	10
08684.003	33,7 1"	<b>3,802</b>	10
08684.004	42,4 1"1/4	<b>4,902</b>	10
08684.005	48,3 1"1/2	<b>5,753</b>	10
08684.006	60,3 2"	<b>7,503</b>	10
08684.007	76,1 2"1/2	<b>10,004</b>	10
08684.008	88,9 3"	<b>10,755</b>	10
08684.009	114,3 4"	<b>17,808</b>	10

**art. 8686**

Tee a saldare mm 2, AISI 304



08686.001	26,9 3/4"	<b>18,258</b>	10
08686.002	33,7 1"	<b>19,008</b>	10
08686.003	42,4 1"1/4	<b>20,509</b>	10
08686.004	48,3 1"1/2	<b>23,260</b>	10
08686.005	60,3 2"	<b>31,514</b>	10
08686.006	76,1 2"1/2	<b>45,020</b>	10
08686.007	88,9 3"	<b>59,026</b>	10
08686.008	114,3 4"	<b>81,786</b>	10

**art. 8689**

 Flangia piana acc. inox AISI 304  
 UNI227-2278 PN 10/16, EN 1092 - 1/01

08689.001	15 1/2"	<b>22,010</b>	10
08689.002	20 3/4"	<b>26,011</b>	10
08689.003	25 1"	<b>30,513</b>	10
08689.004	32 1"1/4	<b>49,022</b>	10
08689.005	40 1"1/2	<b>58,026</b>	10
08689.006	50 2"	<b>69,531</b>	10
08689.007	65 2"1/2	<b>85,037</b>	10
08689.008	80 3"	<b>102,545</b>	10
08689.009	100 4"	<b>112,550</b>	10
08689.010	125 5"	<b>145,064</b>	10
08689.011	150 6"	<b>190,084</b>	10
08689.012	200 8"	<b>260,114</b>	10

**art. 8688**

 Cartella di appoggio spess. 2 mm  
 AISI 304

08688.001	20,9 3/4"	<b>2,101</b>	10
08688.002	33,7 1"	<b>2,501</b>	10
08688.003	42,1 1"1/4	<b>2,851</b>	10
08688.004	48,3 1"1/2	<b>3,201</b>	10
08688.005	60,3 2"	<b>5,252</b>	10
08688.006	76,1 2"1/2	<b>5,502</b>	10
08688.007	83,9 3"	<b>8,754</b>	10
08688.008	114,3 4"	<b>11,505</b>	10

I raccordi filettati costituiscono la soluzione ideale per realizzare impianti di irrigazione nei giardini e parchi , impianti di irrigazione in agricoltura, impianti di acquedottistica.

Elettropompe di superficie per approvvigionamento idrico: giardino, casa.



Stazione automatica di raccolta e sollevamento acque

### art. 7600

TI a 90° in PP



cod. art.	mis.	€	conf.
07600.001	1/2"	2,406	50
07600.002	3/4"	2,776	50
07600.003	1"	3,412	20
07600.004	1"1/4	6,333	10
07600.005	1"1/2	10,004	5
07600.006	2"	14,296	5

### art. 7601

Calotta in PP



07601.001	1/2"	0,660	100
07601.002	3/4"	0,745	100
07601.003	1"	0,830	50
07601.004	1"1/4	1,176	50
07601.005	1"1/2	1,861	20
07601.006	2"	2,431	10

### art. 7602

Manicotto in PP



07602.001	1/2"	1,661	100
07602.002	3/4"	1,761	100
07602.003	1"	2,176	50
07602.004	1"1/4	4,012	50
07602.005	1"1/2	4,807	20
07602.006	2"	6,983	10

### art. 7603

Tappo in PP



07603.001	1/2"	0,660	100
07603.002	3/4"	0,745	100
07603.003	1"	1,015	50
07603.004	1"1/4	1,331	50
07603.005	1"1/2	2,531	20
07603.006	2"	3,351	10

### art. 7604

Nipplo in PP



07604.001	1/2"	0,560	100
07604.002	3/4"	0,660	100
07604.003	1"	0,770	50
07604.004	1"1/4	1,331	50
07604.005	1"1/2	1,921	20
07604.006	2"	2,996	10
07604.007	2"1/2	3,111	1
07604.008	3"	3,552	1

### art. 7605

Gomito a 90° in PP



07605.001	1/2"	1,641	100
07605.002	3/4"	1,971	100
07605.003	1"	2,361	50
07605.004	1"1/4	4,502	25
07605.005	1"1/2	7,933	10
07605.006	2"	10,995	5

**art. 7606**

Gomito a 90° M/F in PP

**art. 7607**

Nipplo ridotto in PP

**art. 7608**

Manicotto ridotto in PP

**art. 7609**

Riduzione F/M in PP

**art. 7610**

Bussola di riduzione in PP

**art. 7611**

Portagomma diritto M in PP



cod. art.	mis.	€	conf.
-----------	------	---	-------

07606.001	1/2"	<b>1,676</b>	50
07606.002	3/4"	<b>1,971</b>	50
07606.003	1"	<b>2,411</b>	25
07606.004	1"1/4	<b>4,247</b>	10

07607.001	1/2" x 3/8"	<b>0,695</b>	100
07607.002	3/4" x 1/2"	<b>0,830</b>	100
07607.003	1" x 1/2"	<b>0,890</b>	100
07607.004	1" x 3/4"	<b>0,930</b>	100
07607.005	1"1/4 x 3/4"	<b>1,616</b>	50
07607.006	1"1/4 x 1"	<b>1,661</b>	50
07607.007	1"1/2 x 1"	<b>2,346</b>	20
07607.008	1"1/2 x 1"1/4	<b>2,361</b>	20
07607.010	2" x 1" 1/4	<b>3,226</b>	10
07607.011	2" x 1"1/2	<b>3,266</b>	10
07607.012	2"1/2 x 2"	<b>3,947</b>	1
07607.013	3" x 2"	<b>4,717</b>	1
07607.014	3" x 2"1/2	<b>5,137</b>	1

07608.001	3/4" x 1/2"	<b>1,736</b>	50
07608.002	1" x 3/4"	<b>2,201</b>	50
07608.003	1"1/4 x 1"	<b>2,996</b>	25
07608.004	1"1/2 x 1"	<b>2,726</b>	10
07608.005	1"1/2 x 1"1/4	<b>5,122</b>	10
07608.006	2" x 1"1/2	<b>6,983</b>	5

07609.001	3/4" x 1/2"	<b>1,861</b>	50
07609.002	1" x 1/2"	<b>1,991</b>	50
07609.003	1" x 3/4"	<b>1,991</b>	50
07609.004	1"1/4 x 3/4"	<b>3,229</b>	25
07609.005	1"1/4 x 1"	<b>4,401</b>	25
07609.006	1"1/2 x 1"	<b>4,892</b>	10
07609.007	1"1/2 x 1"1/4	<b>5,127</b>	10
07609.008	2" x 1"1/2	<b>6,983</b>	5

07610.001	3/4" x 1/2"	<b>1,331</b>	50
07610.002	1" x 1/2"	<b>1,441</b>	50
07610.003	1" x 3/4"	<b>1,441</b>	50
07610.004	1"1/4 x 1/2"	<b>2,771</b>	25
07610.005	1"1/4 x 3/4"	<b>2,776</b>	25
07610.006	1"1/4 x 1"	<b>2,776</b>	25
07610.007	1"1/2 x 3/4"	<b>4,147</b>	10
07610.008	1"1/2 x 1"	<b>4,147</b>	10
07610.009	1"1/2 x 1"1/4	<b>4,147</b>	10
07610.010	2" x 1"	<b>5,587</b>	5
07610.011	2" x 1"1/4	<b>5,587</b>	5
07610.012	2" x 1"1/2	<b>5,587</b>	5

07611.001	1/2"x 20	<b>0,845</b>	100
07611.002	3/4"x 25	<b>1,020</b>	100
07611.003	1"x 30	<b>1,211</b>	50
07611.004	1"1/4 x 35	<b>1,981</b>	25
07611.005	1"1/2 x 40	<b>3,647</b>	25

art. **7620**

Bariotto



cod. art.	mis.	€	conf.
07620.001	1/2"x200	5,122	10
07620.002	1/2"x300	5,562	10
07620.003	1/2"x500	8,564	10
07620.004	1/2"x1000	12,806	5
07620.005	3/4"x200	5,562	10
07620.006	3/4"x300	6,203	10
07620.007	3/4"x500	9,584	10
07620.008	3/4"x1000	14,887	5
07620.009	1"x200	8,744	10
07620.010	1"x300	9,764	10
07620.011	1"x500	11,785	10
07620.012	1"x1000	20,069	5
07620.013	1"1/4x200	11,925	5
07620.014	1"1/4x300	13,366	5
07620.015	1"1/4x500	16,267	5
07620.016	1"1/4x1000	26,892	5
07620.017	1"1/2x200	16,467	5
07620.018	1"1/2x300	18,408	5
07620.019	1"1/2x500	22,270	5
07620.020	1"1/2x1000	34,035	5
07620.021	2"x200	20,589	5
07620.022	2"x300	23,570	5
07620.023	2"x500	29,213	5
07620.024	2"x1000	45,980	5

art. **7621**

Calotta Femmina.



07621.001	1/2"	0,720	100
07621.002	3/4"	0,820	100
07621.003	1"	1,641	50
07621.004	1"1/4	3,802	50
07621.005	1"1/2	5,082	20
07621.006	2"	6,923	10

art. **7622**

Tappo Maschio.



07622.001	1/2"	0,720	100
07622.002	3/4"	0,820	100
07622.003	1"	1,381	50
07622.004	1"1/4	2,901	50
07622.005	1"1/2	3,261	20
07622.006	2"	4,062	10

art. **7623**

Niplo



07623.001	1/2"	0,720	100
07623.002	3/4"	0,820	100
07623.003	1"	1,301	50
07623.004	1"1/4	2,321	50
07623.005	1"1/2	3,482	20
07623.006	2"	5,222	10

art. **7624**

Niplo ridotto.



07624.001	3/4"x1/2"	1,060	100
07624.002	1"x3/4"	1,641	100
07624.003	1"1/4 x1"	2,321	50
07624.004	1"1/2x1"	3,482	20
07624.005	1"1/2x 1"1/4	3,482	20
07624.006	2"x1"1/2	4,622	10

**art. 7625**

Manicotto

**art. 7626**

Manicotto ridotto

**art. 7627**

TI a 90°

**art. 7628**

Gomito a 90° F.F.

**art. 7629**

Gomito a 90° F.F.

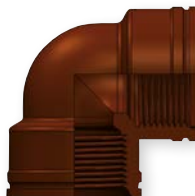
**art. 7630**

Gomito a 90° M/F

**art. 7631**

Bussola di riduzione



cod. art.	mis.	€	conf.
07625.001	1/2"	<b>1,060</b>	100
07625.002	3/4"	<b>1,521</b>	50
07625.003	1"	<b>1,881</b>	50
07625.004	1"1/4	<b>4,842</b>	25
07625.005	1"1/2	<b>6,343</b>	10
07625.006	2"	<b>8,284</b>	5

07626.001	3/4" x 1/2"	<b>1,521</b>	50
07626.002	1" x 3/4"	<b>2,021</b>	50

07627.001	1/2"	<b>1,881</b>	50
07627.002	3/4"	<b>2,561</b>	50
07627.003	1"	<b>3,722</b>	20
07627.004	1"1/4	<b>9,244</b>	10
07627.005	1"1/2	<b>11,085</b>	5
07627.006	2"	<b>16,527</b>	5

07628.001	1/2"	<b>1,060</b>	100
07628.002	3/4"	<b>1,521</b>	100
07628.003	1"	<b>2,781</b>	50

07629.004	1"1/4	<b>6,923</b>	25
07629.005	1"1/2"	<b>8,784</b>	10
07629.006	2"	<b>14,186</b>	5

07630.001	1/2"	<b>1,381</b>	50
07630.002	3/4"	<b>1,881</b>	50
07630.003	1"	<b>2,781</b>	25

07631.001	3/4" x 1/2"	<b>1,181</b>	50
07631.002	1" x 1/2"	<b>1,721</b>	50
07631.003	1" x 3/4"	<b>1,641</b>	50
07631.004	1"1/4 x 1/2"	<b>4,622</b>	25
07631.005	1"1/4 x 3/4"	<b>4,622</b>	25
07631.006	1"1/4 x 1"	<b>3,482</b>	25
07631.007	1"1/2 x 3/4"	<b>5,002</b>	10
07631.008	1"1/2 x 1"	<b>4,622</b>	10
07631.009	1"1/2 x 1"1/4	<b>3,802</b>	10
07631.010	2" x 1"	<b>6,923</b>	5
07631.011	2" x 1"1/4	<b>6,723</b>	5
07631.012	2" x 1"1/2	<b>5,763</b>	5

**art. 7162**

Valvola a sfera F in PP



cod. art.	mis.	€	conf.
07162.001	1/2"	14,277	5
07162.002	3/4"	16,843	5
07162.003	1"	18,599	5

**art. 7163**

Valvola a sfera M in PP



07163.001	1/2"	14,122	5
07163.002	3/4"	16,661	5
07163.003	1"	18,399	5

**art. 7164**Valvola a cilindro F in PP  
Ghiera mobile, guarnizione EPDM,  
portagomma diritto

07164.001	1"x 20	9,489	10
07164.002	1"x 25	9,489	10

**art. 7165**Valvola a cilindro M in PP  
Passa parete, portagomma diritto

07165.001	1"x 20	8,364	10
07165.002	1"x 25	8,364	10

**art. 7146**

Valvola a sfera in PP filetto lungo



07146.001	1/2"x 20	19,546	10
07146.002	3/4"x 25	22,019	10
07146.003	1"x 30	26,345	10

**art. 7147**

Valvola di fondo in POM



07147.001	1"1/4	12,005	10
07147.002	1"1/2	13,855	10
07147.003	2"	17,354	10

**art. 7148**

Valvola di fondo in POM



07148.001	1/2"	9,177	10
07148.002	3/4"	10,422	10
07148.003	1"	13,010	10

**art. 7149**Attacco per serbatoio in PP.  
Collare, guarnizione in EPDM

07149.001	1/2"	3,913	50
07149.002	3/4"	4,153	50
07149.003	1"	4,522	50
07149.004	1"1/4	5,336	20
07149.005	1"1/2	6,283	20
07149.006	2"	7,225	10

**art. 7151**Attacco per serbatoi estremità filettata  
maschio G1 munita di collare di serraggio e  
due guarnizioni piane in EPDM

07151.012	1/2"	3,206	10
07151.034	3/4"	3,717	10
07151.100	1"	4,229	10
07151.114	1"1/4	5,011	10
07151.112	1"1/2	7,132	10
07151.200	2"	7,977	10

**art. 7166**

Raccordo rapido ridotto MF a innesto per serbatoi in PE o Acciaio Inox. Estremità Maschio filettata G1 munita di guarnizione in EPDM alimentare, Anello piano rigido in PP, Collare di serraggio nero filettatura Femmina ridotta G



cod. art.	mis.	€	conf.
07166.304	3/4" x 1/2 int.	<b>22,072</b>	10
07166.100	1" x 3/4 int.	<b>22,850</b>	10
07166.114	1"1/4 x 1" int.	<b>30,996</b>	5
07166.112	1"1/2 x 1"1/4 int.	<b>35,055</b>	5
07166.200	2" x 1"1/2 int.	<b>39,737</b>	5

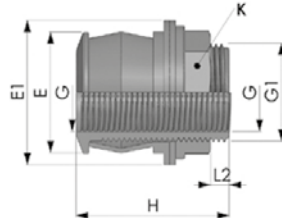

G1	G	E	E1	H	L2	K
3/4"	1/2"	35	43	52	4	32
1"	3/4"	43	53	56	7	41
1" 1/4	1"	52	62	65	6	50
1" 1/2	1" 1/4	59	68	75	16	57
2"	1" 1/2	70	80	91	31	70

**art. 7612**

Adattatore F.F. in P.P. con filetto S6OX6 e guarnizioni in EPM Per cisterna



07612.000	F. 1"	<b>26,397</b>	5
07612.001	F. 1"1/2	<b>31,204</b>	5
07612.002	F. 2"	<b>31,204</b>	5

**art. 7613**

Adattatore M.F. in P.P. con filetto S6OX6 e guarnizioni in EPM Per cisterna



07613.000	M 1"	<b>26,397</b>	5
-----------	------	---------------	---

**art. 7614**

Kit cisterna completo  
N.1 Adattatore P.P. M 1"  
N.1 Rubinetto in P.P.A. a Portagomma  
N.1 Calotta in P.P. 1"

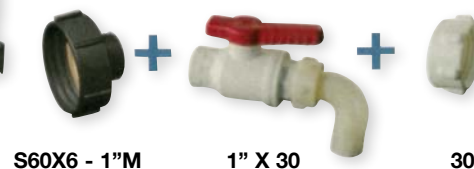

07614.000		<b>63,678</b>	5
-----------	--	---------------	---

### art. 7152

Raccordo tre pezzi diritto.



cod. art.	mis.	€	conf.
07152.020	20	3,927	10
07152.025	25	4,187	10
07152.030	30	5,032	10
07152.035	35	6,103	10
07152.040	40	6,568	10
07152.050	50	11,255	10

### art. 7153

Raccordo tre pezzi diritto.



07153.342	3/4"x 20	3,992	10
07153.125	1"x 25	4,322	10
07153.130	1"x 30	4,992	10
07153.143	1"1/4 x 35	6,688	10
07153.144	1"1/4 x 40	7,183	10
07153.140	1"1/2 x 40	7,183	10
07153.150	1"1/2 x 50	10,630	10

### art. 7154

Raccordo tre pezzi curvo con accoppiamento conico - estremità filettata maschio G1 - estremità portagomma per tubo DN.



07154.342	20x3/4"	4,602	10
07154.125	25x1"	5,507	10
07154.130	30x1"	6,568	10
07154.143	35x1"1/4	8,439	10
07154.144	40x1"1/4	9,969	10
07154.140	40x1"1/2	9,979	10
07154.150	50x1"1/2	14,101	10

### art. 7155

Portagomma dritto per tubo DN - estremità filettata ghiera mobile femmina G e guarnizione piana EPDM.



07155.010	3/8"x 10	2,046	10
07155.013	1/2"x 13	2,366	10
07155.020	3/4"x 20	2,541	10
07155.025	1"x 25	3,046	10
07155.030	1"1/4 x 30	4,307	10
07155.040	1"1/2 x 40	5,903	10
07155.050	2"x 50	7,984	10

### art. 7156

Portagomma diritto par tubo DN - estremità filettata maschio G1.



07156.010	3/8"x 10	1,171	10
07156.013	1/2"x 13	1,246	10
07156.020	3/4"x 20	1,666	10
07156.025	1"x 25	2,066	10
07156.030	1"x 30	2,361	10
07156.035	1"1/4 x 35	3,291	10
07156.040	1"1/4 x 40	4,167	10
07156.140	1"1/2 x 40	4,307	10
07156.150	1"1/2 x 50	5,252	10



**art. 7157**

Calotta - estremità filettata femmina G.



cod. art.	mis.	€	conf.
07157.038	3/8"	<b>1,030</b>	10
07157.012	1/2"	<b>1,065</b>	10
07157.034	3/4"	<b>1,331</b>	10
07157.100	1"	<b>1,371</b>	10

**art. 7158**

Tappo - estremità filettata maschio G1.



07158.038	3/8"	<b>0,825</b>	10
07158.012	1/2"	<b>0,980</b>	10
07158.034	3/4"	<b>1,236</b>	10
07158.100	1"	<b>1,376</b>	10

**art. 7159**

Nipplo - estremità filettate maschio G1.



07159.038	3/8"	<b>0,930</b>	10
07159.012	1/2"	<b>1,130</b>	10
07159.034	3/4"	<b>1,411</b>	10
07159.100	1"	<b>2,021</b>	10
07159.114	1"1/4	<b>2,611</b>	10
07159.112	1"1/2	<b>4,322</b>	10
07159.200	2"	<b>4,627</b>	10

**art. 7160**

Nipplo ridotto - estremità filettate maschio G1-G1(1).

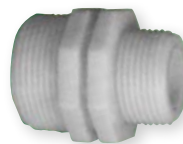

07160.012	1/2"x3/8"	<b>1,236</b>	10
07160.034	3/4"x1/2"	<b>1,411</b>	10
07160.100	1"X3/4"	<b>1,986</b>	10
07160.114	1"1/4x1"	<b>2,981</b>	10
07160.112	1"1/2x1"	<b>3,266</b>	10
07160.124	1"1/2x1"1/4	<b>3,482</b>	10
07160.200	2"x1"1/2	<b>5,267</b>	10

**art. 7161**

Collare con filettatura femmina cilindrica G.



07161.038	3/8"	<b>0,805</b>	10
07161.012	1/2"	<b>0,925</b>	10
07161.034	3/4"	<b>0,985</b>	10
07161.100	1"	<b>1,436</b>	10
07161.114	1"1/4	<b>1,856</b>	10
07161.112	1"1/2	<b>2,171</b>	10
07161.200	2"	<b>2,906</b>	10

## art. 243B

Prolunga in barra **PESANTE** ottone cromato  
interno esagonale



cod. art.	mis.	€	conf.
0243B.011	3/8"x10	2,138	25
0243B.012	3/8"x15	2,605	25
0243B.013	3/8"x20	3,272	25
0243B.014	3/8"x25	3,564	25
0243B.015	3/8"x30	4,131	10
0243B.016	3/8"x40	4,919	10
0243B.017	3/8"x50	5,903	10
0243B.018	3/8"x60	7,253	10
0243B.001	1/2 x 10	2,459	25
0243B.002	1/2 x 15	3,001	25
0243B.003	1/2 x 20	3,585	25
0243B.004	1/2 x 25	4,169	25
0243B.005	1/2 x 30	4,919	25
0243B.006	1/2 x 40	6,211	25
0243B.007	1/2 x 50	7,503	25
0243B.008	1/2 x 60	8,962	25
0243B.009	1/2 x 80	14,381	25
0243B.010	1/2 x 100	18,216	5
0243B.019	3/4"x10	3,564	10
0243B.020	3/4"x15	4,302	10
0243B.021	3/4"x20	5,040	10
0243B.022	3/4"x25	5,778	10
0243B.023	3/4"x30	6,515	10
0243B.024	3/4"x40	8,116	10
0243B.025	3/4"x50	9,467	10
0243B.026	3/4"x60	14,265	10
0243B.027	1"x10	6,149	10
0243B.028	1"x15	7,132	10
0243B.029	1"x20	8,237	10
0243B.030	1"x30	10,575	10
0243B.031	1"x40	12,789	5
0243B.032	1"x50	15,494	5

## art. 243BG

Prolunga in barra **PESANTE** ottone giallo  
interno esagonale



243BG.011	3/8"x10	1,959	25
243BG.012	3/8"x15	2,376	25
243BG.013	3/8"x20	2,918	25
243BG.014	3/8"x25	3,210	25
243BG.015	3/8"x30	3,710	10
243BG.016	3/8"x40	4,419	10
243BG.017	3/8"x50	5,419	10
243BG.018	3/8"x60	6,628	10
243BG.001	1/2 x 10	2,251	25
243BG.002	1/2 x 15	2,710	25
243BG.003	1/2 x 20	3,210	25
243BG.004	1/2 x 25	3,793	25
243BG.005	1/2 x 30	4,419	25
243BG.006	1/2 x 40	5,669	25
243BG.007	1/2 x 50	6,878	25
243BG.008	1/2 x 65	8,129	25
243BG.009	1/2 x 80	13,423	25
243BG.010	1/2 x 100	16,716	5
243BG.019	3/4"x10	3,197	10
243BG.020	3/4"x15	3,935	10
243BG.021	3/4"x20	4,673	10
243BG.022	3/4"x25	5,240	10
243BG.023	3/4"x30	6,003	10
243BG.024	3/4"x40	7,378	10
243BG.025	3/4"x50	8,729	10
243BG.026	3/4"x60	13,035	10
243BG.027	1"x10	5,411	10
243BG.028	1"x15	6,269	10
243BG.029	1"x20	7,378	10
243BG.030	1"x30	9,592	10
243BG.031	1"x40	11,067	5
243BG.032	1"x50	13,527	5

**art. 243**

Prolunga in ottone cromato.



cod. art.	mis.	€	conf.
00243.009	1/2"x10	<b>1,918</b>	25
00243.010	1/2"x15	<b>2,209</b>	25
00243.011	1/2"x20	<b>2,626</b>	10
00243.012	1/2"x25	<b>2,960</b>	10
00243.013	1/2"x30	<b>3,460</b>	10
00243.014	1/2"x40	<b>4,169</b>	10
00243.015	1/2"x50	<b>4,794</b>	10
00243.016	1/2"x60	<b>5,919</b>	10
00243.017	1/2"x80	<b>7,878</b>	10
00243.018	1/2"x100	<b>10,338</b>	5

**art. 243G**

Prolunga in ottone giallo.



0243G.009	1/2"x10	<b>1,626</b>	25
0243G.010	1/2"x15	<b>1,876</b>	25
0243G.011	1/2"x20	<b>2,251</b>	10
0243G.012	1/2"x25	<b>2,501</b>	10
0243G.013	1/2"x30	<b>2,835</b>	10
0243G.014	1/2"x40	<b>3,460</b>	10
0243G.015	1/2"x50	<b>3,877</b>	10
0243G.016	1/2"x60	<b>4,919</b>	10
0243G.017	1/2"x80	<b>6,253</b>	10
0243G.018	1/2"x100	<b>8,629</b>	5

**art. 246**

Gomito in ottone cromato M.F.

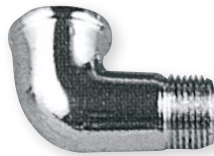

00246.001	3/8" •	<b>4,877</b>	10
00246.002	1/2" •	<b>4,585</b>	10
00246.003	3/4" •	<b>6,753</b>	10
00246.004	1" •	<b>12,547</b>	5
00246.005	1"1/4	<b>17,966</b>	5
00246.006	1"1/2	<b>24,594</b>	1
00246.007	2	<b>47,479</b>	1

• CROMATO LUCIDO

**art. 246G**

Gomito in ottone giallo M.F.



0246G.001	3/8"	<b>4,002</b>	10
0246G.002	1/2"	<b>3,793</b>	10
0246G.003	3/4"	<b>6,169</b>	10
0246G.004	1"	<b>9,838</b>	5
0246G.005	1"1/4	<b>16,466</b>	5
0246G.006	1"1/2	<b>23,844</b>	1
0246G.007	2	<b>46,229</b>	1

**art. 246FR**

Gomito in ottone giallo M.M.



246FR.000	1/2"x1/2"	<b>4,277</b>	10
246FR.001	3/4"x 3/4"	<b>6,294</b>	10
246FR.002	1"x1"	<b>9,504</b>	10

**art. 247**

Gomito in ottone cromato F.F.

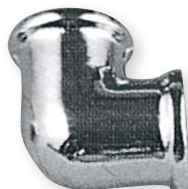

00247.001	3/8" •	<b>4,835</b>	10
00247.002	1/2" •	<b>5,419</b>	10
00247.003	3/4" •	<b>6,878</b>	10
00247.004	1" •	<b>12,672</b>	5
00247.005	1"1/4	<b>18,925</b>	5
00247.006	1"1/2	<b>27,054</b>	1
00247.007	2"	<b>47,979</b>	1

• CROMATO LUCIDO

**art. 247G**

Gomito in ottone giallo F.F.



cod. art.	mis.	€	conf.
0247G.001	3/8"	3,918	10
0247G.002	1/2"	4,335	10
0247G.003	3/4"	5,627	10
0247G.004	1"	10,588	5
0247G.005	1"1/4	17,216	5
0247G.006	1"1/2	24,594	1
0247G.007	2"	46,729	1

**art. 247GF**

Gomito in ottone giallo F.F.F.



247GF.001	1/2"x1/2"	9,346	10
247GF.002	3/4"x3/4"	11,067	10

**art. 971**

Codolo F sede piana con calotta per circolatori + guarnizione



00971.001	F3/4 x 1"1/4	9,132	2
00971.002	F1" x 1"1/2F	10,812	2
00971.003	F1"1/4 x 2"F	19,082	2

**art. 484PC**

Gomito 90° F. F. ridotto in ottone cromato.



484PC.001	3/8 x 3/4	8,004	10
484PC.002	1/2 x 3/4	6,378	10
484PC.003	1/2 x 1"	11,672	5
484PC.004	3/4 x 1"	10,088	5

**art. 484PG**

Gomito 90° F. F. ridotto in ottone giallo.



484PG.001	3/8 x 3/4	7,753	10
484PG.002	1/2 x 3/4	6,169	10
484PG.003	1/2 x 1"	11,297	10
484PG.004	3/4 x 1"	9,713	10

**art. 500RC**

Gomito 90° M. F. ridotto in ottone cromato.



500RC.001	1/2 x 3/4	6,878	10
500RC.002	3/4 x 1"	10,838	10

**art. 501RG**

Gomito 90° M. F. ridotto in ottone giallo.



501RG.001	1/2 x 3/4	6,378	10
501RG.003	3/4 x 1"	10,338	10

**art. 483PG**

Nipples DX/SX per gas  
in ottone giallo.



cod. art.	mis.	€	conf.
<b>483PG.102</b>	1/2	<b>3,460</b>	10

**art. 475PG**

Nipples filetto lungo **PESANTE**  
in ottone giallo.



<b>475PG.102</b>	1/2	<b>3,126</b>	10
<b>475PG.304</b>	3/4	<b>4,544</b>	10
<b>475PG.100</b>	1"	<b>9,337</b>	10
<b>475PG.114</b>	1"1/4	<b>17,716</b>	5

**art. 246M**

Gomito MF. flangiato cromato.



<b>0246M.000</b>	1/2"	<b>8,129</b>	10
<b>246MG.000</b>	1/2"	<b>6,878</b>	10

**art. 246MG**

Gomito MF. flangiato giallo.

**art. 247F**

Gomito FF. flangiato cromato.



<b>0247F.000</b>	1/2"	<b>7,628</b>	10
<b>247FG.000</b>	1/2"	<b>6,628</b>	10

**art. 247FG**

Gomito FF. flangiato giallo.

**art. 248**

T.E. in ottone cromato F.F.



<b>00248.001</b>	3/8" •	<b>5,919</b>	10
<b>00248.002</b>	1/2" •	<b>5,294</b>	10
<b>00248.003</b>	3/4" •	<b>7,003</b>	10
<b>00248.004</b>	1" •	<b>13,756</b>	5
<b>00248.005</b>	1"1/4	<b>23,135</b>	1
<b>00248.006</b>	1"1/2	<b>32,473</b>	1
<b>00248.007</b>	2"	<b>42,560</b>	1

• CROMATO LUCIDO

**art. 248G**

T.E. in ottone giallo F.F.



<b>0248G.001</b>	3/8"	<b>4,669</b>	10
<b>0248G.002</b>	1/2"	<b>4,460</b>	10
<b>0248G.003</b>	3/4"	<b>5,836</b>	10
<b>0248G.004</b>	1"	<b>11,672</b>	5
<b>0248G.005</b>	1"1/4	<b>21,134</b>	1
<b>0248G.006</b>	1"1/2	<b>31,472</b>	1
<b>0248G.007</b>	2"	<b>41,060</b>	1
<b>248GR.001</b>	3/4x1/2x3/4	<b>6,878</b>	10
<b>248GR.002</b>	1"x1/2x1"	<b>14,506</b>	5
<b>248GR.003</b>	1"x3/4x1"	<b>13,298</b>	5

**art. 248GR**

T.E. in ottone giallo ridotto.

art. **248FR**  
Tee in ottone giallo F.M.M.



cod. art.	mis.	€	conf.
<b>248FR.000</b>	1/2"x 1/2"x 1/2"	<b>5,227</b>	10
<b>248FR.001</b>	3/4"x 3/4"x3/4"	<b>8,266</b>	10

art. **248MR**  
Tee in ottone giallo F.M.F.



<b>248MR.000</b>	1/2"x 1/2"x 1/2"	<b>4,990</b>	10
<b>248MR.001</b>	3/4"x 3/4"x3/4"	<b>7,316</b>	10

art. **248C**  
Croce 4 vie ottone giallo.



<b>0248C.001</b>	1/2"	<b>7,128</b>	10
<b>0248C.002</b>	3/4"	<b>11,297</b>	5
<b>0248C.003</b>	1"	<b>18,216</b>	5
<b>0248C.004</b>	1"1/4	<b>28,763</b>	1
<b>0248C.005</b>	1"1/2	<b>41,310</b>	1
<b>0248C.006</b>	2"	<b>50,439</b>	1

art. **475**  
Vite doppia in ottone cromato.



<b>00475.001</b>	1/4" •	<b>1,334</b>	25
<b>00475.002</b>	3/8" •	<b>1,709</b>	25
<b>00475.003</b>	1/2" •	<b>1,959</b>	25
<b>00475.004</b>	3/4" •	<b>2,876</b>	10
<b>00475.005</b>	1"	<b>4,877</b>	10
<b>00475.006</b>	1"1/4	<b>8,837</b>	10
<b>00475.007</b>	1"1/2	<b>10,588</b>	5
<b>00475.008</b>	2"	<b>17,216</b>	5

• CROMATO LUCIDO

art. **475G**  
Vite doppia in ottone giallo.



<b>0475G.001</b>	1/4"	<b>1,251</b>	25
<b>0475G.002</b>	3/8"	<b>1,542</b>	25
<b>0475G.003</b>	1/2"	<b>1,834</b>	25
<b>0475G.004</b>	3/4"	<b>2,584</b>	10
<b>0475G.005</b>	1"	<b>4,419</b>	10
<b>0475G.006</b>	1"1/4	<b>7,878</b>	10
<b>0475G.007</b>	1"1/2	<b>9,838</b>	5
<b>0475G.008</b>	2"	<b>15,757</b>	5

art. **476**  
Vite doppia ridotta in ottone cromato.



<b>00476.001</b>	1/4"x3/8" •	<b>1,792</b>	25
<b>00476.002</b>	1/4"x1/2" •	<b>2,126</b>	25
<b>00476.003</b>	3/8"x1/2" •	<b>2,043</b>	25
<b>00476.004</b>	3/8"x3/4" •	<b>3,793</b>	25
<b>00476.005</b>	1/2"x3/4"	<b>3,085</b>	10
<b>00476.006</b>	1/2"x1"	<b>4,710</b>	10
<b>00476.007</b>	3/4"x1"	<b>5,294</b>	10
<b>00476.008</b>	3/4"x1"1/4	<b>8,129</b>	10
<b>00476.009</b>	1"x1"1/4	<b>7,753</b>	10
<b>00476.010</b>	1"x1"1/2	<b>10,338</b>	5
<b>00476.011</b>	1"1/4x1"1/2	<b>10,838</b>	5
<b>00476.012</b>	1"1/2x2"	<b>19,175</b>	5

• CROMATO LUCIDO

**art. 476G**

Vite doppia ridotta in ottone giallo.



cod. art.	mis.	€	conf.
0476G.001	1/4"x3/8"	1,584	25
0476G.002	1/4"x1/2"	1,959	25
0476G.003	3/8"x1/2"	1,876	25
0476G.004	3/8"x3/4"	3,385	25
0476G.005	1/2"x3/4"	2,710	10
0476G.006	1/2"x1"	4,335	10
0476G.007	3/4"x1"	4,794	10
0476G.008	3/4"x1"1/4	7,378	10
0476G.009	1"x1"1/4	7,128	10
0476G.010	1"x1"1/2	9,838	5
0476G.011	1"1/4x1"1/2	10,088	5
0476G.012	1"1/2x2"	17,716	5

**art. 475L**

Niples prolungato cromato lucido.

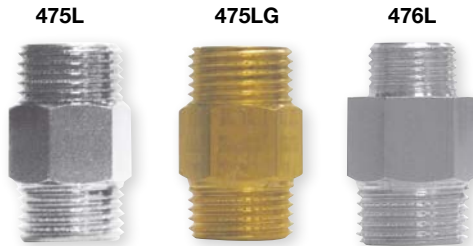

0475L.000	1/2x1/2	4,002	25
475LG.000	1/2x1/2	2,593	25

**art. 475LG**

Niples prolungato giallo.

**art. 476L**

Niples prolungato ridotto cromato.

0476L.000	1/2x3/8	3,613	25
-----------	---------	-------	----

**art. 477**

Riduzione esagonale in ottone cromato.



00477.001	1/4"x3/8" •	1,626	25
00477.002	1/4"x1/2" •	2,251	25
00477.003	3/8"x1/2" •	1,584	25
00477.004	3/8"x3/4" •	3,335	10
00477.005	1/2"x3/4"	1,918	25
00477.006	1/2"x1"	4,919	10
00477.007	3/4"x1"	3,710	10
00477.008	1/2"x1"1/4	9,379	10
00477.009	3/4"x1"1/4	8,254	10
00477.010	1"x1"1/4	6,670	10
00477.011	3/4"x1"1/2	11,839	5
00477.012	1"x1"1/2	9,754	5
00477.013	1"1/4x1"1/2	7,045	10

• CROMATO LUCIDO

**art. 477G**

Riduzione esagonale in ottone giallo.



0477G.001	1/4"x3/8"	1,376	25
0477G.002	1/4"x1/2"	2,084	25
0477G.003	3/8"x1/2"	1,334	25
0477G.004	3/8"x3/4"	3,085	10
0477G.005	1/2"x3/4"	1,709	10
0477G.006	1/2"x1"	4,460	10
0477G.007	3/4"x1"	3,335	10
0477G.008	1/2"x1"1/4	8,879	10
0477G.009	3/4"x1"1/4	7,753	10
0477G.010	1"x1"1/4	6,044	10
0477G.011	3/4"x1"1/2	11,088	5
0477G.012	1"x1"1/2	9,254	5
0477G.013	1"1/4x1"1/2	6,545	10

**art. 478**

Manicotto in ottone cromato.



00478.001	1/4" •	1,709	25
00478.002	3/8" •	2,293	25
00478.003	1/2" •	2,960	10
00478.004	3/4" •	3,918	10
00478.005	1"	7,253	10
00478.006	1"1/4	8,629	5
00478.007	1"1/2	14,756	5
00478.008	2"	24,594	1

• CROMATO LUCIDO

**art. 478G**

Manicotto in ottone giallo.



cod. art.	mis.	€	conf.
0478G.001	1/4"	1,542	25
0478G.002	3/8"	2,084	25
0478G.003	1/2"	2,584	10
0478G.004	3/4"	3,376	10
0478G.005	1"	6,628	10
0478G.006	1"1/4	8,129	5
0478G.007	1"1/2	13,756	5
0478G.008	2"	22,635	1

**art. 479**

Tappo femmina in ottone cromato.

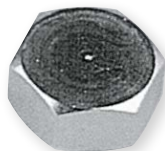

00479.001	3/8" •	1,417	25
00479.002	1/2" •	1,542	25
00479.003	3/4" •	2,459	25
00479.004	1" •	3,627	10
00479.005	1"1/4	5,419	10
00479.006	1"1/2	7,878	10
00479.007	2"	15,257	5

• CROMATO LUCIDO

**art. 479G**

Tappo femmina in ottone giallo.



0479G.001	3/8"	1,251	25
0479G.002	1/2"	1,292	25
0479G.003	3/4"	1,959	25
0479G.004	1"	3,085	10
0479G.005	1"1/4	4,919	10
0479G.006	1"1/2	7,128	10
0479G.007	2"	14,506	5

**art. 480**

Tappo maschio in ottone cromato.



00480.001	3/8" •	1,426	25
00480.002	1/2" •	1,626	25
00480.003	3/4" •	2,418	25
00480.004	1"	3,918	10
00480.005	1"1/4	6,378	10
00480.006	1"1/2	11,297	10
00480.007	2"	18,466	5

• CROMATO LUCIDO

**art. 480G**

Tappo maschio in ottone giallo.



0480G.001	3/8"	1,292	25
0480G.002	1/2"	1,417	25
0480G.003	3/4"	2,209	25
0480G.004	1"	3,710	10
0480G.005	1"1/4	6,044	10
0480G.006	1"1/2	10,338	10
0480G.007	2"	17,216	5

**art. 481**

Prolunga ridotto M.F. in ottone cromato.



00481.001	M.1/4"x F.3/8" •	2,251	25
00481.003	M.3/8"x F.3/4" •	4,169	25
00481.005	M.1/2"x F.1"	4,544	10
00481.006	M.3/4"x F.1"	4,794	10
00481.007	M.3/4"x F.1"1/4	7,378	10
00481.008	M.1"x F.1"1/4	7,253	10

• CROMATO LUCIDO

**art. 481PC**Prolunga ridotta **PESANTE**  
in ottone cromato lucido .

481PC.001	M 3/8 x 1/2F	3,001	25
481PC.002	M 1/2 x 3/4F	3,376	10



**art. 481G**

Prolunga ridotto M.F. in ottone giallo.



cod. art.	mis.	€	conf.
0481G.001	M.1/4"x F.3/8"	<b>1,959</b>	10
0481G.003	M.3/8"x F.3/4"	<b>3,710</b>	10
0481G.005	M.1/2"x F.1"	<b>4,043</b>	10
0481G.006	M.3/4"x F.1"	<b>4,169</b>	10
0481G.007	M.3/4"x F.1"1/4	<b>6,753</b>	10
0481G.008	M.1"x F.1"1/4	<b>6,503</b>	10

**art. 481PG**

 Prolunga ridotta **PESANTE**  
in ottone giallo.

481PG.001	M 3/8 x 1/2F	<b>2,705</b>	25
481PG.002	M 1/2 x 3/4F	<b>3,085</b>	10

**art. 482**

Manicotto ridotto F.F. in ottone cromato.



00482.001	3/8"x1/2" •	<b>3,210</b>	25
00482.002	1/2"x3/4" •	<b>4,294</b>	10
00482.003	3/4"x1" •	<b>5,544</b>	10
00482.004	1/2"x1" •	<b>5,419</b>	10
00482.005	3/4"x1"1/4	<b>11,797</b>	10
00482.006	1"x1"1/4	<b>9,838</b>	10
00482.007	1"x1"1/2	<b>19,050</b>	5
00482.008	1"1/4x1"1/2	<b>15,007</b>	5
00482.009	1"1/2"x2"	<b>27,054</b>	1
00482.010	1"1/4x2"	<b>27,804</b>	1

• CROMATO LUCIDO

**art. 482G**

Manicotto ridotto F.F. in ottone giallo.



0482G.001	3/8"x1/2"	<b>2,710</b>	25
0482G.002	1/2"x3/4"	<b>3,835</b>	10
0482G.003	3/4"x1"	<b>4,669</b>	10
0482G.004	1/2"x1"	<b>4,585</b>	10
0482G.005	3/4"x1"1/4	<b>11,297</b>	10
0482G.006	1"x1"1/4	<b>9,087</b>	10
0482G.007	1"x1"1/2	<b>18,466</b>	5
0482G.008	1"1/4x1"1/2	<b>14,256</b>	5
0482G.009	1"1/2"x2"	<b>24,594</b>	1
0482G.010	1"1/4x2"	<b>25,344</b>	1

**art. 253**

Dado esagonale in ottone cromato.



00253.001	Ø 26 1"	<b>2,441</b>	10
00253.003	Ø 32 1"1/4	<b>2,976</b>	10

**art. 377A**

Riduzione in ottone cromata lucida.



0377A.001	M 1"x1"1/4 F	<b>4,877</b>	10
0377A.002	M 1"1/4x1"1/2 F	<b>6,878</b>	10
0377A.003	M 1"1/4x1" F	<b>5,669</b>	10
0377A.004	M 1"1/2x1"1/4 F	<b>6,169</b>	10

**art. 259**

Raccordo portagomma in ottone giallo per rubinetti.

**art. 260**

Raccordo portagomma in ottone cromato per rubinetti.  
(misura corrispondente al rubinetto)

cod. art.	mis.	€	conf.
00259.001	3/8"	<b>3,086</b>	25
00259.002	1/2"	<b>3,334</b>	50
00259.003	3/4"	<b>5,291</b>	25
00259.004	1"	<b>7,644</b>	10
00260.002	1/2"	<b>2,261</b>	50
00260.003	3/4"	<b>3,875</b>	25
00260.004	1"	<b>7,804</b>	10

**art. 972**

Codolo sede piana con calotta cromata.



00972.001	3/8x1/2	<b>3,290</b>	50
00972.002	1/2x1/2	<b>5,869</b>	50
00972.003	1/2x3/4	<b>4,446</b>	50
00972.004	3/4x1"	<b>6,047</b>	50
00972.005	1"x1"1/4	<b>9,204</b>	50

**art. 972G**

Codolo sede piana con calotta giallo.



0972G.001	3/8x1/2	<b>2,623</b>	50
0972G.002	1/2x1/2	<b>5,247</b>	50
0972G.003	1/2x3/4	<b>3,824</b>	50
0972G.004	3/4x1"	<b>5,247</b>	50
0972G.005	1"x1"1/4	<b>7,870</b>	50
0972G.006	1"1/4x1"1/2	<b>13,917</b>	50

**art. 940**

Raccordo P.G. per GPL maschio, giallo.  
A norme UNI - GIG.



00940.000	1/4"x 9	<b>2,223</b>	10
00940.001	3/8"x 9	<b>3,602</b>	10
00940.002	1/2"x 9	<b>4,269</b>	10
940CR.001	3/8"x 9	<b>3,957</b>	10
940CR.002	1/2"x 9	<b>4,580</b>	10

**art. 940CR**

Idem cromato.

**art. 941**

Raccordo P.G. per GPL femmina, giallo.  
A norme UNI - GIG.



00941.000	1/4"x 9	<b>2,921</b>	10
00941.001	3/8"x 9	<b>3,602</b>	10
00941.002	1/2"x 9	<b>4,269</b>	10
941CR.001	3/8"x 9	<b>3,957</b>	10
941CR.002	1/2"x 9	<b>4,580</b>	10

**art. 941CR**

Idem cromato.

**art. 942**

Gomito P.G. per GPL maschio, giallo.



00942.001	3/8"x10	<b>4,980</b>	10
00942.002	1/2"x10	<b>5,780</b>	10
942CR.001	3/8"x10	<b>5,380</b>	10
942CR.002	1/2"x10	<b>6,314</b>	10

**art. 942CR**

Idem cromato.

**art. 943**

Gomito P.G. per GPL femmina, giallo.



00943.001	3/8"x10	<b>4,713</b>	10
00943.002	1/2"x10	<b>4,580</b>	10
943CR.001	3/8"x10	<b>5,113</b>	10
943CR.002	1/2"x10	<b>4,980</b>	10

**art. 943CR**

Idem cromato.

**art. 944**

Raccordo P.G. per gas metano maschio, giallo.  
A norme UNI - GIG.

**art. 944CR**

Idem cromato.

**art. 945**

Raccordo P.G. per gas femmina, giallo.  
A norme UNI - GIG.

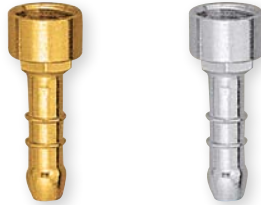
**art. 945CR**

Idem cromato.

**art. 946**

Gomito P.G. per gas metano maschio, giallo.

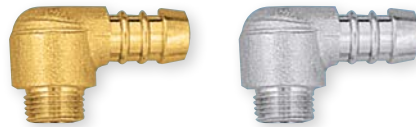
**art. 946CR**

Idem cromato.

**art. 947**

Gomito P.G. per gas metano femmina, giallo.

**art. 947CR**

Idem cromato.

**art. 948**

Raccordo portagomma, maschio.  
Giallo tipo Roma.

**art. 949**

Raccordo portagomma, femmina.  
Giallo tipo Roma.



cod. art.	mis.	€	conf.
00944.001	3/8" x 14	<b>4,446</b>	10
00944.002	1/2" x 14	<b>5,247</b>	10
<b>944CR.001</b>	3/8" x 14	<b>4,847</b>	10
<b>944CR.002</b>	1/2" x 14	<b>5,647</b>	10

00945.001	3/8" x 14	<b>4,446</b>	10
00945.002	1/2" x 14	<b>5,247</b>	10
<b>945CR.001</b>	3/8" x 14	<b>4,847</b>	10
<b>945CR.002</b>	1/2" x 14	<b>5,647</b>	10

00946.001	3/8"x15	<b>4,847</b>	10
00946.002	1/2"x15	<b>5,647</b>	10
<b>946CR.001</b>	3/8"x15	<b>5,247</b>	10
<b>946CR.002</b>	1/2"x15	<b>6,180</b>	10

00947.001	3/8"x15	<b>4,580</b>	10
00947.002	1/2"x15	<b>4,446</b>	10
<b>947CR.001</b>	3/8"x15	<b>4,980</b>	10
<b>947CR.002</b>	1/2"x15	<b>4,847</b>	10

00948.011	1/4"x10	<b>1,441</b>	25
00948.012	3/8"x13	<b>2,205</b>	25
00948.001	3/8"x15	<b>2,223</b>	25
00948.002	1/2"x15	<b>2,757</b>	25
00948.003	3/4"x20	<b>4,713</b>	10
00948.004	1"x25	<b>5,780</b>	10
00948.005	1"1/4x30	<b>11,827</b>	5
00948.006	1"1/2x40	<b>15,473</b>	1
00948.007	2"x50	<b>20,987</b>	1
00948.008	2"1/2x60	<b>60,338</b>	1
00948.009	3"x80	<b>97,065</b>	1
00948.010	4"x100	<b>143,485</b>	1

**A RICHIESTA ALTRE MISURE**

00949.011	1/4"x10	<b>1,441</b>	25
00949.012	3/8"x10	<b>2,623</b>	25
00949.001	3/8"x15	<b>2,623</b>	25
00949.002	1/2"x15	<b>3,157</b>	25
00949.003	3/4"x20	<b>3,691</b>	10
00949.004	1"x25	<b>6,581</b>	10
00949.005	1"1/4x30	<b>19,031</b>	5
00949.006	1"1/2x40	<b>24,144</b>	5
00949.007	2"x50	<b>26,234</b>	5

**A RICHIESTA ALTRE MISURE**

### art. 431

Raccordo cassone diritto.



cod. art.	mis.	€	conf.
00431.001	3/8"	9,575	30
00431.002	1/2"	11,600	20
00431.003	3/4"	15,834	15
00431.004	1"	22,097	10
00431.005	1"1/4	31,121	5
00431.006	1"1/2	40,873	4
00431.007	2"	56,165	1

### art. 432

Raccordo cassone con codulo.

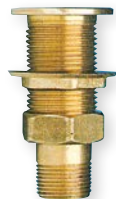

00432.001	1/2"	16,575	20
00432.002	3/4"	17,790	20
00432.003	1"	22,097	10
00432.004	1"1/4	30,566	5

### art. 433

Raccordo cassone con tappo.



00433.001	1/2"	8,839	20
00433.002	3/4"	12,888	20
00433.003	1"	16,390	10
00433.004	1"1/4	23,019	5

### art. 434

Raccordo cassone curvo senza sfiato.



00434.001	1/2"	17,863	12
00434.002	3/4"	24,307	10
00434.003	1"	33,882	6

### art. 435

Ghiera rosetta per raccordi cassone flangiato.



00435.001	3/8"	1,568	25
00435.002	1/2"	1,963	25
00435.003	3/4"	2,549	25
00435.004	1"	3,136	10
00435.005	1"1/4	3,728	10
00435.006	1"1/2	4,902	10
00435.007	2"	9,606	5

### art. 437G

Controdado senza flangia.



0437G.001	3/8"	1,490	50
0437G.002	1/2"	1,600	50
0437G.003	3/4"	1,843	50
0437G.004	1"	3,710	25

**art. 439**

Raccordo Excelsior curvo.



cod. art.	mis.	€	conf.
00439.001	1/2"x15	<b>9,510</b>	20
00439.002	3/4"x20	<b>18,034</b>	10
00439.003	1"x30	<b>33,129</b>	10
00439.004	1"1/4x35	<b>47,830</b>	10
00439.005	1"1/2x40	<b>55,084</b>	5
00439.006	2"x50	<b>98,012</b>	1
00439.007	2"1/2x60	<b>160,739</b>	1

**art. 441**

Raccordo portagomma 3 pezzi.

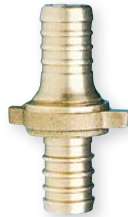

00441.001	mm. 15	<b>9,803</b>	25
00441.002	mm. 20	<b>14,508</b>	12
00441.003	mm. 25	<b>18,818</b>	10
00441.004	mm. 30	<b>25,875</b>	10

**art. 442**

Raccordo Excelsior diritto 3 pezzi.



00442.001	1/2"x15	<b>9,212</b>	20
00442.002	3/4"x20	<b>13,527</b>	20
00442.003	1"x30	<b>26,265</b>	10
00442.004	1"1/4x35	<b>35,679</b>	10
00442.005	1"1/2x40	<b>41,360</b>	4
00442.006	2"x50	<b>68,024</b>	1
00442.007	2"1/2x60	<b>125,455</b>	1

**art. 436**

Valvola tipo Catania.



00436.001	Ø 30	<b>12,743</b>	20
00436.002	Ø 35	<b>14,985</b>	20
00436.003	Ø 40	<b>16,082</b>	15

**art. 438**

Valvola filettata lunga.



00438.000	1"	<b>8,235</b>	20
-----------	----	--------------	----

**art. 554**

Piletta altissima filettata con codulo calotta e controdado.



00554.001	1"	<b>26,728</b>	10
00554.002	1"1/4	<b>36,533</b>	5

### art. 1486

Raccordo in ottone giallo a 5 vie, tipo prolungato.

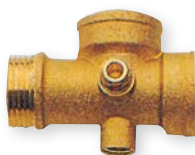

cod. art.	mis.	€	conf.
01486.000	1"	15,473	1

### art. 451

Bocchettone diritto M.F. con tenuta O.R. giallo.



00451.001	1/2"	6,590	10
00451.002	3/4"	9,390	10
00451.003	1"	16,024	5
00451.004	1"1/4	20,331	5
00451.005	1" 1/2	40,145	5
00451.006	2"	76,242	1
451CR.001	1/2"	7,107	10
451CR.002	3/4"	9,907	10
451CR.003	1"	17,014	5
451CR.004	1"1/4	21,623	5
451CR.005	1"1/2	41,955	5
451CR.006	2"	85,158	1

### art. 451CR

Idem cromato.

### art. 452

Bocchettone curvo M.F. con tenuta O.R. giallo.

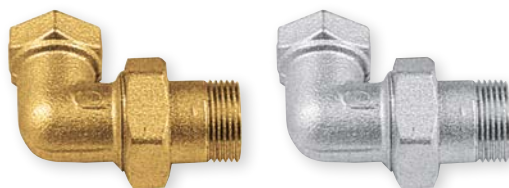

00452.001	1/2"	8,916	10
00452.002	3/4"	12,965	10
00452.003	1"	22,097	5
00452.004	1"1/4	27,955	5
00452.005	1"1/2	52,120	5
452CR.001	1/2"	9,390	10
452CR.002	3/4"	13,741	10
452CR.003	1"	22,873	5
452CR.004	1"1/4	29,248	5
452CR.005	1"1/2	53,369	5

### art. 452CR

Idem cromato.

### art. 458

Bocchettone diritto F.F., ORing.

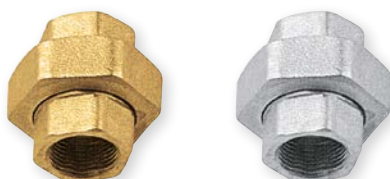

00458.001	1/2"	10,166	5
00458.002	3/4"	16,024	5
00458.003	1"	19,297	5
458CR.001	1/2"	10,682	5
458CR.002	3/4"	16,756	5
458CR.003	1"	20,331	5

### art. 458CR

Idem cromato.

### art. 244

Ghiera filettata in ottone giallo.



00244.001	3/8"x1/4"	0,756	25
00244.002	1/2"x3/8"	0,992	25
00244.003	3/4"x1/2"	1,323	25
00244.004	1"x3/4"	2,079	25
00244.005	1"1/4x1	3,496	25
00244.006	1"1/2x1"1/4	3,779	25

### art. 244B

Ghiera con battuta



0244B.000	3/8"x1/2"	1,087	25
0244B.001	1/2"x3/4"	1,795	25
0244B.002	3/4"x1"	2,504	25
0244B.003	1"x1"1/4	3,732	25
0244B.004	1"1/4x3"1/2	5,008	25

**art. 245**

Tutto filetto in ottone giallo mm 40.

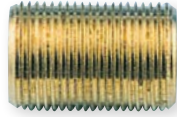

cod. art.	mis.	€	conf.
00245.001	3/8"	<b>2,787</b>	10
00245.002	1/2"	<b>3,354</b>	10
00245.003	3/4"	<b>4,677</b>	10
00245.004	1"	<b>6,283</b>	10
00245.005	1"1/4	<b>8,079</b>	10

**art. 241**

Barilotti in ottone giallo.



00241.001	1/2x60	<b>4,724</b>	10
00241.002	1/2x80	<b>5,858</b>	10
00241.003	1/2x100	<b>7,228</b>	10
00241.004	1/2x150	<b>11,149</b>	10
00241.005	1/2x200	<b>13,937</b>	10
00241.006	3/4x60	<b>6,142</b>	10
00241.007	3/4x80	<b>7,512</b>	10
00241.008	3/4x100	<b>8,645</b>	10
00241.009	3/4x150	<b>13,086</b>	10
00241.010	3/4x200	<b>17,007</b>	10
00241.011	1"x60	<b>8,929</b>	10
00241.012	1"x80	<b>10,582</b>	10
00241.013	1"x100	<b>12,283</b>	10
00241.014	1"x150	<b>19,228</b>	10
00241.015	1"x200	<b>25,086</b>	10

**art. 241S**

Barilotto scorrevole in ottone giallo.



0241S.001	1/2x100	<b>8,929</b>	10
0241S.002	1/2x150	<b>11,716</b>	10
0241S.003	3/4x100	<b>10,866</b>	10
0241S.004	3/4x150	<b>13,937</b>	10
0241S.005	1x150	<b>20,787</b>	10
0241S.006	11/4x150	<b>30,661</b>	10

**art. 8001**

Curva a 90° M/F.



cod. art.	mis.	€	conf.
08001.001	1/4"	4,536	500
08001.002	3/8"	5,544	90
08001.003	1/2"	4,140	100
08001.004	3/4"	7,178	70
08001.005	1"	9,781	55
08001.006	1"1/4"	16,854	30
08001.007	1"1/2"	22,289	20
08001.008	2"	35,937	12
08001.009	2"1/2"	80,753	8
08001.010	3"	103,793	4
08001.011	4"	188,484	1

**art. 8002**

Curva a 90° F/F.



* 08002.001	1/4"	4,828	450
* 08002.002	3/8"	5,544	80
08002.003	1/2"	4,661	70
08002.004	3/4"	7,202	60
08002.005	1"	9,781	30
08002.006	1"1/4"	16,916	25
08002.007	1"1/2"	20,795	20
08002.008	2"	28,880	10
08002.009	2"1/2"	81,321	8
08002.010	3"	102,237	5
08002.011	4"	193,962	1

**art. 8040**

Curva a 45° M/F.



* 08040.001	3/8"	6,085	130
* 08040.002	1/2"	4,575	80
08040.003	3/4"	6,330	50
08040.004	1"	8,836	35
08040.005	1"1/4"	11,536	35
08040.006	1"1/2"	18,344	25
08040.007	2"	27,888	20
08040.008	2"1/2"	64,623	1
08040.009	3"	70,459	1
08040.010	4"	193,129	1

**art. 8041**

Curva a 45° F/F.



* 08041.001	3/8"	6,999	120
* 08041.002	1/2"	5,579	60
08041.003	3/4"	7,069	40
08041.004	1"	9,018	25
08041.005	1"1/4"	16,177	30
08041.006	1"1/2"	21,352	20
08041.007	2"	29,969	15
08041.008	2"1/2"	59,164	8
08041.009	3"	75,117	5
* 08041.010	4"	203,541	2

**art. 8085**

Curva di sorpasso.

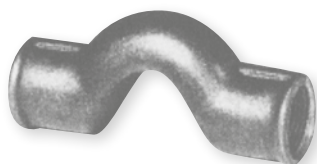

* 08085.001	3/8"	12,606	90
* 08085.002	1/2"	7,209	100
* 08085.003	3/4"	10,847	20
* 08085.004	1"	22,713	25

\* Solo raccorderia ghisa cuore bianco "EU" (già compreso aumento. 35%)

Per raccorderia ghisa cuore bianco "EU" aumento. 35%



**art. 8090**

Gomito 90° F/F.

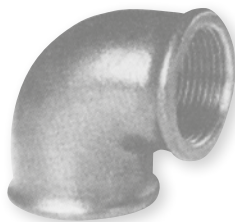

cod. art.	mis.	€	conf.
* 08090.001	1/8"	<b>4,801</b>	300
* 08090.002	1/4"	<b>2,937</b>	180
08090.003	3/8"	<b>2,155</b>	300
08090.004	1/2"	<b>1,447</b>	220
08090.005	3/4"	<b>2,319</b>	140
08090.006	1"	<b>3,400</b>	120
08090.007	1.1/4"	<b>6,505</b>	60
08090.008	1.1/2"	<b>10,470</b>	40
08090.009	2"	<b>12,341</b>	20
08090.010	2.1/2"	<b>36,155</b>	12
08090.011	3"	<b>49,543</b>	8
08090.012	4"	<b>88,850</b>	4
* 08090.013	5"	<b>346,166</b>	2

**art. 8090R**

Gomito ridotto 90° F/F.

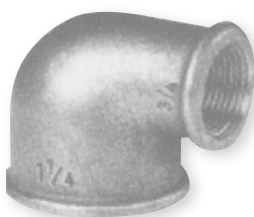

* 8090R.001	3/8"x1/4"	<b>4,575</b>	130
8090R.002	1/2"x3/8"	<b>2,790</b>	200
* 8090R.003	3/4"x3/8"	<b>5,490</b>	80
8090R.004	3/4"x1/2"	<b>3,116</b>	160
8090R.005	1"x1/2"	<b>4,575</b>	40
8090R.006	1"x3/4"	<b>4,793</b>	30
8090R.007	1.1/4"x3/4"	<b>9,781</b>	30
8090R.008	1.1/4"x1"	<b>7,770</b>	25
8090R.009	1.1/2"x3/4"	<b>11,940</b>	25
8090R.010	1.1/2"x1"	<b>8,268</b>	20
8090R.011	1.1/2"x1.1/4"	<b>12,364</b>	35
8090R.012	2"x1"	<b>19,577</b>	10
8090R.013	2"x1.1/4"	<b>21,219</b>	10
8090R.014	2"x1.1/2"	<b>19,924</b>	10
8090R.015	2.1/2"x2"	<b>48,193</b>	5
* 8090R.016	3"x2.1/2"	<b>84,924</b>	1

**art. 8092**

Gomito 90° M/F.

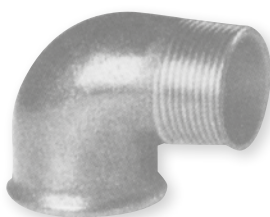

* 08092.001	1/8"	<b>5,781</b>	100
* 08092.002	1/4"	<b>3,163</b>	200
08092.003	3/8"	<b>2,428</b>	150
08092.004	1/2"	<b>1,700</b>	180
08092.005	3/4"	<b>2,646</b>	150
08092.006	1"	<b>4,424</b>	80
08092.007	1.1/4"	<b>7,594</b>	40
08092.008	1.1/2"	<b>11,407</b>	30
08092.009	2"	<b>15,002</b>	20
08092.010	2.1/2"	<b>37,311</b>	10
08092.011	3"	<b>49,173</b>	6
08092.012	4"	<b>83,990</b>	4

**art. 8096**

Gomito F/F con bocchettone sede conica.

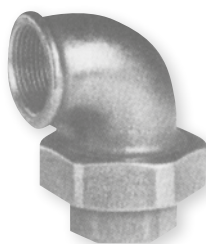

* 08096.001	3/8"	<b>16,414</b>	60
08096.002	1/2"	<b>10,046</b>	70
08096.003	3/4"	<b>11,613</b>	50
08096.004	1"	<b>16,667</b>	50
08096.005	1.1/4"	<b>27,748</b>	20
08096.006	1.1/2"	<b>33,105</b>	15
08096.007	2"	<b>55,818</b>	10
* 08096.008	2.1/2"	<b>145,057</b>	4
* 08096.009	3"	<b>188,406</b>	4

\* Solo raccorderia ghisa cuore bianco "EU" (già compreso aumento. 35%)  
 Per raccorderia ghisa cuore bianco "EU" aumento. 35%

**art. 8098**

Gomito M/F con bocchettone sede conica.

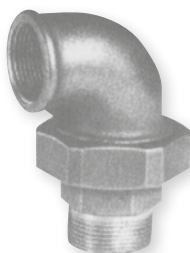

cod. art.	mis.	€	conf.
* 08098.001	3/8"	14,457	50
08098.002	1/2"	10,088	60
08098.003	3/4"	12,777	40
08098.004	1"	17,508	25
08098.005	1.1/4"	29,335	30
08098.006	1.1/2"	35,937	20
08098.007	2"	59,448	10
* 08098.008	2.1/2"	160,137	5
* 08098.009	3"	214,652	4

**art. 8120**

Gomito a 45° F/F.



08120.001	1/2"	4,925	90
08120.002	3/4"	6,046	60
08120.003	1"	8,801	40
* 08120.004	1.1/4"	19,445	25
* 08120.005	1.1/2"	23,744	15
* 08120.006	2"	30,954	2

**art. 8121**

Gomito a 45° M/F.

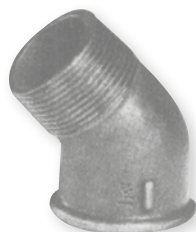

* 08121.001	1/2"	5,478	210
* 08121.002	3/4"	6,956	110
* 08121.003	1"	10,742	60
* 08121.004	1.1/4"	19,986	50
* 08121.005	1.1/2"	21,562	35
* 08121.006	2"	27,289	30

**art. 8130**

Tee.



* 08130.001	1/8"	6,124	200
* 08130.002	1/4"	4,287	140
08130.003	3/8"	3,019	200
08130.004	1/2"	2,027	150
08130.005	3/4"	3,400	90
08130.006	1"	5,011	50
08130.007	1.1/4"	8,801	50
08130.008	1.1/2"	13,703	40
08130.009	2"	19,313	20
08130.010	2.1/2"	44,174	8
08130.011	3"	58,958	6
08130.012	4"	115,613	4
* 08130.013	5"	512,217	1
* 08130.014	6"	717,925	1

**art. 8130R**

Tee ridotto.



* 8130R.001	1/2"x1/4"x1/2"	6,019	300
8130R.002	1/2"x3/8"x1/2"	4,723	180
* 8130R.003	1/2"x3/8"x3/8"	5,490	800
* 8130R.004	1/2"x1/2"x3/8"	5,490	120
8130R.005	1/2"x3/4"x1/2"	4,435	30
* 8130R.006	1/2"x1"x1/2"	11,718	120
* 8130R.007	3/4"x3/8"x1/2"	6,272	150
* 8130R.008	3/4"x3/8"x3/4"	5,743	40
8130R.010	3/4"x1/2"x1/2"	3,898	80
8130R.011	3/4"x1/2"x3/4"	3,638	110
* 8130R.012	3/4"x3/4"x1/2"	5,567	40
8130R.014	3/4"x1"x3/4"	7,517	60
* 8130R.015	1"x3/8"x1"	9,843	100

\* Solo raccorderia ghisa cuore bianco "EU" (già compreso aumento. 35%)

Per raccorderia ghisa cuore bianco "EU" aumento. 35%

**art. 8130R**

Tee ridotto.



cod. art.	mis.	€	conf.
8130R.016	1"x1/2"x1/2"	8,213	30
* 8130R.017	1"x1/2"x3/4"	6,999	100
8130R.018	1"x1/2"x1"	4,727	80
* 8130R.019	1"x3/4"x1/2"	8,941	30
8130R.020	1"x3/4"x3/4"	5,937	30
8130R.021	1"x3/4"x1"	5,097	60
8130R.022	1"x1"x1/2"	6,241	40
8130R.023	1"x1"x3/4"	6,875	40
* 8130R.024	1"x1"x1/4x1"	14,275	60
* 8130R.025	1"x1"x1/2x1"	17,870	50
8130R.026	1"x1/4x1/2"x1"	9,236	75
8130R.027	1"x1/4x1/2"x1"x1/4	7,910	60
* 8130R.028	1"x1/4x3/4"x3/4"	14,407	80
* 8130R.029	1"x1/4x3/4"x1"	13,002	75
8130R.030	1"x1/4x3/4"x1"x1/4	8,380	55
* 8130R.031	1"x1/4x1"x1/2"	20,807	70
* 8130R.032	1"x1/4x1"x3/4"	15,224	75
* 8130R.033	1"x1/4x1"x1"	12,672	35
8130R.034	1"x1/4x1"x1"x1/4	9,345	40
* 8130R.035	1"x1/4x1"x1/4x1/2"	14,827	15
* 8130R.036	1"x1/4x1"x1/4x3/4"	17,169	30
* 8130R.037	1"x1/4x1"x1/4x1"	14,457	15
* 8130R.038	1"x1/4x1"x1/2x1"x1/4	22,488	40
8130R.039	1"x1/2x1/2"x1"x1/2	10,652	30
8130R.040	1"x1/2x3/4"x1"x1/2	11,524	30
* 8130R.041	1"x1/2x1"x1"	17,317	55
8130R.042	1"x1/2x1"x1"x1/2	12,442	25
8130R.043	1"x1/2x1"x1/4x1"x1/4	17,461	35
8130R.044	1"x1/2x1"x1/4x1"x1/2	16,897	20
* 8130R.045	1"x1/2x1"x1/2x1/2"	21,721	40
* 8130R.046	1"x1/2x1"x1/2x3/4"	24,445	40
* 8130R.047	1"x1/2x1"x1/2x1"	24,114	40
8130R.048	1"x1/2x1"x1/2x1"x1/4	20,546	30
* 8130R.049	1"x1/2x2"x1"x1/2	28,230	25
8130R.050	2"x1/2"x2"	15,710	20
8130R.051	2"x3/4"x2"	20,402	20
8130R.052	2"x1"x2"	15,839	25
* 8130R.053	2"x1"x1/4x1"x1/4	28,705	25
8130R.054	2"x1"x1/4x2"	20,402	20
8130R.055	2"x1"x1/2x1"x1/2	24,651	20
8130R.056	2"x1"x1/2x2"	23,538	20
* 8130R.057	2"x2"x1"	29,180	20
* 8130R.058	2"x2"x1"x1/4	48,613	20
* 8130R.059	2"x2"x1"x1/2	31,918	20
* 8130R.060	2"x2"x1/2x2"	57,663	14
8130R.061	2"x1/2x1"x2"x1/2	32,343	10
8130R.062	2"x1/2x1"x1/4x2"x1/2	44,458	10
8130R.063	2"x1/2x1"x1/2x2"x1/2	38,684	10
* 8130R.064	2"x1/2x2"x2"	65,809	14
8130R.065	2"x1/2x2"x2"x1/2	43,509	10
8130R.066	3"x1"x3"	53,095	5
8130R.067	3"x1"x1/4x3"	61,059	5
8130R.068	3"x1"x1/2x3"	61,222	5
8130R.069	3"x2"x3"	56,865	3
8130R.070	3"x2"x1/2x3"	67,257	2
8130R.071	4"x2"x4"	100,210	8
8130R.072	4"x2"x1/2x4"	128,024	4
8130R.073	4"x3"x4"	106,552	4

\* Solo raccorderia ghisa cuore bianco "EU" (già compreso aumento. 35%)

Per raccorderia ghisa cuore bianco "EU" aumento. 35%

art. **8180**

Croce.

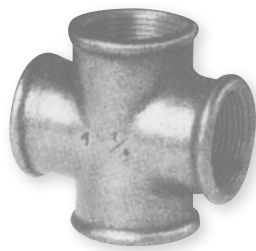

cod. art.	mis.	€	conf.
* 08180.001	3/8"	8,653	60
08180.002	1/2"	7,069	40
08180.003	3/4"	10,512	50
08180.004	1"	13,018	35
08180.005	1"1/4	17,461	30
08180.006	1"1/2	28,265	20
08180.007	2"	34,763	16
08180.008	2"1/2	78,664	10
08180.009	3"	90,647	5
* 08180.010	4"	182,547	5

art. **8221**

Distribuzione a gomito.



* 08221.001	3/8"	10,505	90
08221.002	1/2"	6,622	100
08221.003	3/4"	10,512	30
08221.004	1"	13,932	50
08221.005	1.1/4"	24,651	35
08221.006	1.1/2"	35,000	25
08221.007	2"	53,542	18

art. **8240**

Manicotto ridotto F/F.



* 08240.001	3/8"x1/4"	3,505	180
* 08240.002	1/2"x1/4"	3,731	150
08240.003	1/2"x3/8"	2,537	130
* 08240.004	3/4"x1/4"	6,404	80
* 08240.005	3/4"x3/8"	4,221	80
08240.006	3/4"x1/2"	2,996	80
08240.007	1"x1/2"	3,758	50
08240.008	1"x3/4"	3,420	50
08240.009	1"1/4x1/2"	7,159	40
08240.010	1"1/4x3/4"	6,330	40
08240.011	1"1/4x1"	6,124	70
* 08240.012	1"1/2x1/2"	13,360	30
08240.013	1"1/2x3/4"	9,781	30
08240.014	1"1/2x1"	7,439	25
08240.015	1"1/2x1"1/4	8,213	25
* 08240.016	2"x1/2"	18,519	15
* 08240.017	2"x3/4"	19,192	15
08240.018	2"x1"	14,609	35
08240.019	2"x1"1/4	12,886	30
08240.020	2"x1"1/2	12,255	30
* 08240.021	2"1/2x1"1/4	39,011	10
08240.022	2"1/2x1"1/2	38,890	15
08240.023	2"1/2x2"	33,008	15
08240.024	3"x1"1/2	35,634	8
08240.025	3"x2"	51,994	15
08240.026	3"x2"1/2	59,230	10
* 08240.027	4"x2"	109,357	4
08240.028	4"x2"1/2	94,121	4
08240.029	4"x3"	96,572	4

\* Solo raccorderia ghisa cuore bianco "EU" (già compreso aumento. 35%)

Per raccorderia ghisa cuore bianco "EU" aumento. 35%

**art. 8241**

Riduzione maschio femmina.

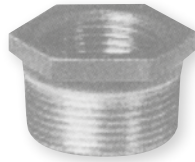

cod. art.	mis.	€	conf.
* 08241.001	1/4"x1/8"	<b>3,957</b>	180
* 08241.002	3/8"x1/8"	<b>4,046</b>	150
* 08241.003	3/8"x1/4"	<b>2,354</b>	130
* 08241.004	1/2"x1/8"	<b>1,945</b>	80
* 08241.005	1/2"x1/4"	<b>1,513</b>	80
08241.006	1/2"x3/8"	<b>1,513</b>	80
* 08241.007	3/4"x1/4"	<b>3,268</b>	50
* 08241.008	3/4"x3/8"	<b>2,459</b>	50
08241.009	3/4"x1/2"	<b>1,611</b>	40
* 08241.010	1"x1/4"	<b>3,167</b>	40
* 08241.011	1"x3/8"	<b>4,128</b>	70
08241.012	1"x1/2"	<b>2,288</b>	30
08241.013	1"x3/4"	<b>2,081</b>	30
* 08241.014	1"1/4x3/8"	<b>7,579</b>	25
08241.015	1"1/4x1/2"	<b>3,828</b>	25
08241.016	1"1/4x3/4"	<b>3,420</b>	15
08241.017	1"1/4x1"	<b>2,537</b>	15
* 08241.018	1"1/2x3/8"	<b>6,419</b>	35
08241.019	1"1/2x1/2"	<b>5,077</b>	30
08241.020	1"1/2x3/4"	<b>5,599</b>	30
08241.021	1"1/2x1"	<b>3,758</b>	10
08241.022	1"1/2x1"1/4	<b>3,824</b>	15
08241.023	2"x1/2"	<b>10,178</b>	15
08241.024	2"x3/4"	<b>10,038</b>	8
08241.025	2"x1"	<b>8,213</b>	15
08241.026	2"x1"1/4	<b>7,843</b>	10
08241.027	2"x1"1/2	<b>7,026</b>	4
* 08241.028	2"1/2x1"	<b>19,570</b>	4
08241.029	2"1/2"x1"1/4	<b>18,706</b>	4
08241.030	2"1/2x1"1/2	<b>17,671</b>	4
08241.031	2"1/2x2"	<b>13,539</b>	4
* 08241.032	3"x1"	<b>30,744</b>	4
08241.033	3"x1"1/4	<b>25,328</b>	4
08241.034	3"x1"1/2	<b>23,499</b>	4
08241.035	3"x2"	<b>17,430</b>	4
08241.036	3"x2"1/2	<b>19,729</b>	4
* 08241.037	4"x1"1/2	<b>55,359</b>	4
08241.038	4"x2"	<b>50,722</b>	4
08241.039	4"x2"1/2	<b>37,735</b>	4
08241.040	4"x3"	<b>36,210</b>	4
* 08241.041	5"x4"	<b>a richiesta</b>	4
* 08241.042	6"x4"	<b>a richiesta</b>	4

**art. 8245**

Nipplo ridotto.

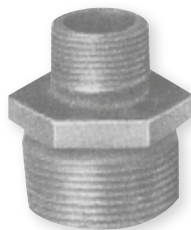

* 08245.001	3/8"x1/4"	<b>3,731</b>	200
* 08245.002	1/2"x1/4"	<b>4,575</b>	140
08245.003	1/2"x3/8"	<b>3,540</b>	180
08245.004	3/4"x3/8"	<b>6,276</b>	90
08245.005	3/4"x1/2"	<b>3,093</b>	90
08245.006	1"x1/2"	<b>6,233</b>	60
08245.007	1"x3/4"	<b>3,540</b>	60
* 08245.008	1"1/4x1/2"	<b>11,497</b>	30
08245.009	1"1/4x3/4"	<b>8,092</b>	40
08245.010	1"1/4x1"	<b>6,797</b>	40
08245.011	1"1/2x3/4"	<b>8,213</b>	35
08245.012	1"1/2x1"	<b>15,811</b>	30
08245.013	1"1/2x1"1/4	<b>7,069</b>	25
08245.014	2"x1"	<b>11,711</b>	20
08245.015	2"x1"1/4	<b>14,609</b>	20
08245.016	2"x1"1/2	<b>13,345</b>	15
08245.017	2"1/2x1"1/2	<b>19,239</b>	10
08245.018	2"1/2x2"	<b>31,950</b>	10
08245.019	3"x2"	<b>39,350</b>	15
08245.020	3"x2"1/2	<b>51,679</b>	8
* 08245.021	4"x2"1/2	<b>119,422</b>	15
* 08245.022	4"x3"	<b>117,625</b>	15

\* Solo raccorderia ghisa cuore bianco "EU" (già compreso aumento. 35%)  
 Per raccorderia ghisa cuore bianco "EU" aumento. 35%

art. **8246**

Manicotto ridotto M/F.

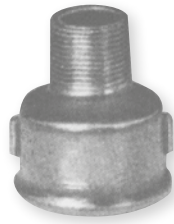

cod. art.	mis.	€	conf.
* 08246.001	1/4"x1/8"	2,513	200
* 08246.002	3/8x1/4"	3,268	210
* 08246.003	1/2"x1/4"	4,221	140
08246.004	1/2"x3/8"	2,832	130
* 08246.005	3/4"x3/8"	5,743	70
08246.006	3/4"x1/2"	3,062	70
08246.007	1"x1/2"	4,661	50
08246.008	1"x3/4"	4,941	50
* 08246.009	1"1/4x1/2"	14,496	35
08246.010	1"1/4x3/4"	8,836	35
08246.011	1"1/4x1"	5,490	35
* 08246.012	1"1/2x3/4"	12,337	25
08246.013	1"1/2x1"	10,512	25
08246.014	1"1/2x1"1/4	9,193	25
* 08246.016	2"x1"	21,418	15
08246.017	2"x1"1/4	14,924	15
08246.018	2"x1"1/2	19,103	15
* 08246.019	2"1/2x2"	31,059	10
* 08246.020	3"x2"	45,252	6
* 08246.021	3"x2"1/2	55,398	6

art. **8270**

Manicotto.



* 08270.001	1/8"	3,824	300
* 08270.002	1/4"	2,910	250
08270.003	3/8"	2,039	350
08270.004	1/2"	1,677	300
08270.005	3/4"	2,288	200
08270.006	1"	3,019	130
08270.007	1"1/4	4,727	70
08270.008	1"1/2	6,828	50
08270.009	2"	10,119	35
08270.010	2"1/2	27,954	15
08270.011	3"	33,576	10
08270.012	4"	78,357	5

art. **8271**

Manicotto filettato destro e sinistro.



* 08271.001	3/8"	3,505	200
* 08271.002	1/2"	3,163	220
* 08271.003	3/4"	4,287	150
* 08271.004	1"	5,451	40
* 08271.005	1"1/4	10,438	70
* 08271.006	1"1/2	11,497	50
* 08271.007	2"	20,515	35

art. **8280**

Nipplo doppio.

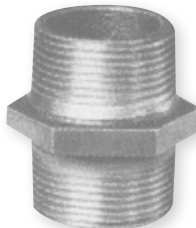

* 08280.001	1/8"	2,257	500
* 08280.002	1/4"	2,976	280
08280.003	3/8"	2,832	220
08280.004	1/2"	1,568	360
08280.005	3/4"	2,027	180
08280.006	1"	2,887	120
08280.007	1"1/4	4,727	60
08280.008	1"1/2	5,459	50
08280.009	2"	9,835	25
08280.010	2"1/2	17,671	20
08280.011	3"	21,266	10
08280.012	4"	78,357	4
* 08280.013	5"	171,264	1
* 08280.014	6"	281,862	1

\* Solo raccorderia ghisa cuore bianco "EU" (già compreso aumento. 35%)

Per raccorderia ghisa cuore bianco "EU" aumento. 35%

**art. 8281**

Nippli con filettatura destra e sinistra.

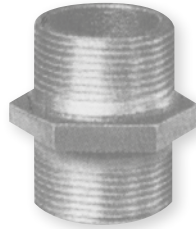

cod. art.	mis.	€	conf.
* 08281.001	3/8"	<b>6,890</b>	700
* 08281.002	1/2"	<b>3,346</b>	400
* 08281.003	3/4"	<b>4,128</b>	250
* 08281.004	1"	<b>6,999</b>	150
* 08281.005	1"1/4	<b>9,921</b>	90
* 08281.006	1"1/2	<b>11,878</b>	75
* 08281.007	2"	<b>21,997</b>	40

**art. 8290**

Tappo con bordo.

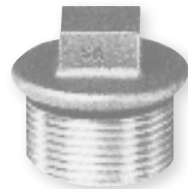

* 08290.001	1/8"	<b>1,455</b>	200
08290.002	1/4"	<b>1,447</b>	400
08290.003	3/8"	<b>1,187</b>	350
08290.004	1/2"	<b>1,187</b>	400
08290.005	3/4"	<b>1,611</b>	260
08290.006	1"	<b>1,774</b>	160
08290.007	1"1/4	<b>3,311</b>	60
08290.008	1"1/2	<b>4,007</b>	50
08290.009	2"	<b>7,190</b>	60
08290.010	2"1/2	<b>15,687</b>	15
08290.011	3"	<b>20,184</b>	10
08290.012	4"	<b>35,634</b>	5

**art. 8300**

Calotta esagonale.

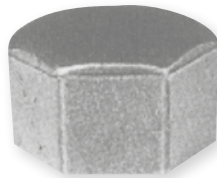

08300.001	3/8"	<b>1,677</b>	280
08300.002	1/2"	<b>1,938</b>	200
08300.003	3/4"	<b>2,288</b>	100
08300.004	1"	<b>2,681</b>	120
08300.005	1"1/4	<b>4,007</b>	120
08300.006	1"1/2	<b>4,988</b>	40
08300.007	2"	<b>9,423</b>	50
08300.008	2"1/2	<b>17,200</b>	30
08300.009	3"	<b>18,737</b>	10
08300.010	4"	<b>40,972</b>	5

**art. 8310**

Controdado.

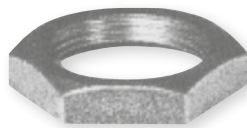

* 08310.001	1/4"	<b>2,062</b>	300
* 08310.002	3/8"	<b>2,155</b>	300
* 08310.003	1/2"	<b>1,747</b>	250
* 08310.004	3/4"	<b>1,840</b>	220
* 08310.005	1"	<b>2,712</b>	120
* 08310.006	1"1/4	<b>2,836</b>	100
* 08310.007	1"1/2	<b>4,338</b>	80
* 08310.008	2"	<b>8,653</b>	50

**art. 8330**

Bocchettone F/F sede piana.

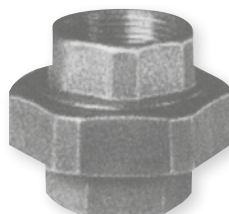

* 08330.001	3/8"	<b>10,808</b>	70
08330.002	1/2"	<b>6,034</b>	100
08330.003	3/4"	<b>7,026</b>	70
08330.004	1"	<b>7,964</b>	70
08330.005	1"1/4	<b>13,749</b>	40
08330.006	1"1/2	<b>17,757</b>	30
08330.007	2"	<b>29,425</b>	20
08330.008	2"1/2	<b>67,432</b>	15
08330.009	3"	<b>99,078</b>	5
08330.010	4"	<b>232,113</b>	4

\* Solo raccorderia ghisa cuore bianco "EU" (già compreso aumento. 35%)  
 Per raccorderia ghisa cuore bianco "EU" aumento. 35%

**art. 8331**

Bocchettone MF sede piana.

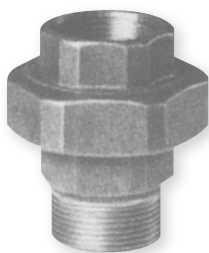

cod. art.	mis.	€	conf.
* 08331.001	3/8"	11,761	60
08331.002	1/2"	7,069	120
08331.003	3/4"	7,921	60
08331.004	1"	9,501	50
08331.005	1"1/4	17,255	30
08331.006	1"1/2	20,819	25
08331.007	2"	32,572	15
* 08331.008	2"1/2	92,122	5
* 08331.009	3"	134,673	4
* 08331.010	4"	317,909	2

**art. 8340**

Bocchettone F/F sede conica.

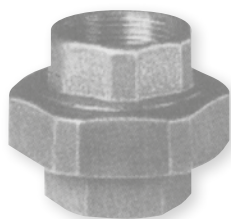

* 08340.001	3/8"	11,761	70
08340.002	1/2"	9,400	100
08340.003	3/4"	8,552	70
08340.004	1"	9,870	70
08340.005	1"1/4	16,854	30
08340.006	1"1/2	19,729	30
08340.007	2"	32,487	20
08340.008	2"1/2	71,474	12
08340.009	3"	99,634	8
08340.010	4"	201,393	2

**art. 8341**

Bocchettone M/F sede conica.

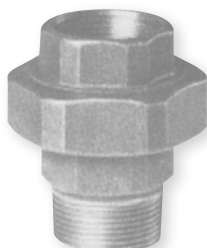

* 08341.001	3/8"	10,610	60
08341.002	1/2"	7,365	120
08341.003	3/4"	8,933	60
08341.004	1"	11,003	50
08341.005	1"1/4	17,515	30
08341.006	1"1/2	22,332	25
08341.007	2"	35,716	15
08341.008	2"1/2	78,022	5
08341.009	3"	121,986	2
08341.010	4"	223,266	2

**art. 8471**

Gomito con flangia.

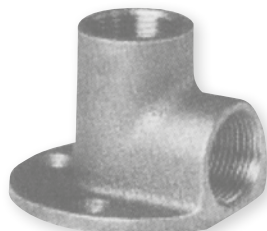

* 08471.001	1/2"	9,100	10
* 08471.002	3/4"	21,733	10

**art. 8529**

Prolungamento.

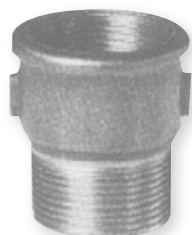

* 08529.001	3/8"	3,626	10
08529.002	1/2"	3,062	10
08529.003	3/4"	4,544	10
08529.004	1"	7,069	10
08529.005	1"1/4	9,018	10
* 08529.006	1"1/2	15,808	10
* 08529.007	2"	26,297	10

\* Solo raccorderia ghisa cuore bianco "EU" (già compreso aumento. 35%)

Per raccorderia ghisa cuore bianco "EU" aumento. 35%



**art. 8531**

Niplo tutto filetto.



cod. art.	mis.	€	conf.
* 08531.001	3/8"	<b>2,739</b>	10
* 08531.002	1/2"	<b>2,591</b>	10
* 08531.003	3/4"	<b>3,638</b>	10
* 08531.004	1"	<b>5,451</b>	10
* 08531.005	1"1/4	<b>13,598</b>	10
* 08531.006	1"1/2	<b>17,936</b>	10
* 08531.007	2"	<b>25,133</b>	10
* 08531.008	2"1/2	<b>46,006</b>	10
* 08531.009	3"	<b>48,205</b>	10
* 08531.010	4"	<b>110,376</b>	10

**art. 8480**

Raccordo a compressione a manicotto in ghisa



08480.001	Ø 1/2"	<b>a richiesta</b>	10
08480.002	Ø 3/4"	<b>a richiesta</b>	10
08480.003	Ø 1"	<b>a richiesta</b>	10
08480.004	Ø 1"1/4	<b>a richiesta</b>	10
08480.005	Ø 1"1/2	<b>a richiesta</b>	10
08480.006	Ø 2"	<b>a richiesta</b>	10

**art. 8481**

Raccordo a compressione filettato M. in ghisa



08481.001	Ø 1/2"	<b>a richiesta</b>	10
08481.002	Ø 3/4"	<b>a richiesta</b>	10
08481.003	Ø 1"	<b>a richiesta</b>	10
08481.004	Ø 1"1/4	<b>a richiesta</b>	10
08481.005	Ø 1"1/2	<b>a richiesta</b>	10
08481.006	Ø 2"	<b>a richiesta</b>	10

**art. 8482**

Raccordo a compressione filettato F.



08482.001	Ø 1/2"	<b>a richiesta</b>	10
08482.002	Ø 3/4"	<b>a richiesta</b>	10
08482.003	Ø 1"	<b>a richiesta</b>	10
08482.004	Ø 1"1/4	<b>a richiesta</b>	10
08482.005	Ø 1"1/2	<b>a richiesta</b>	10
08482.006	Ø 2"	<b>a richiesta</b>	10

## RACCORDI IN OTTONE PER TUBO POLIETILENE

### art. 1360

Raccordo monogiunto maschio per tubo pe  
- innesto rapido brevettato  
collegamento con il tubo in polietilene viene  
effettuato senza smontare il raccordo!!!

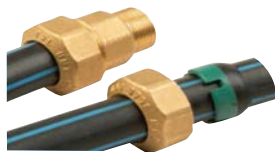

cod. art.	mis.	€	conf.
01360.001	1/2"x20	6,598	25
01360.002	3/4"x25	9,664	15
01360.003	1"x32	14,201	20
01360.004	1"1/4x40	22,585	10
01360.005	1"1/2x50	32,627	8
01360.006	2"x63	52,251	6

### art. 1361

raccordo monogiunto femmina per tubo pe  
- innesto rapido brevettato



01361.001	1/2"x20	6,766	25
01361.002	3/4"x25	9,855	15
01361.003	1"x32	14,181	20
01361.004	1"1/4x40	23,005	10
01361.005	1"1/2x50	32,627	6
01361.006	2"x63	52,251	6

### art. 1362

Raccordo bigiunto per tubo pe - innesto ra-  
pido brevettato



01362.001	ø 20	11,722	30
01362.002	ø 25	17,586	24
01362.003	ø 32	26,199	24
01362.004	ø 40	37,692	10
01362.005	ø 50	41,240	10
01362.006	ø 63	83,784	6

### art. 1363

Raccordo a t con derivazione filettata f. gas  
per tubo pe - innesto rapido brevettato



01363.001	1/2"x20	13,675	20
01363.002	3/4"x25	20,484	20
01363.003	1"x32	30,273	20
01363.004	1"1/4x40	45,108	10
01363.005	1"1/2x50	59,180	10
01363.006	2"x63	107,167	4

### art. 1364

Raccordo a t per tubo pe - innesto rapido  
brevettato



01364.001	ø 20 x 20 x 20	14,220	20
01364.002	ø 25 x 25 x 25	26,725	20
01364.003	ø 32 x 32 x 32	31,514	12
01364.004	ø 40 x 40 x 40	56,978	10
01364.005	ø 50 x 50 x 50	80,423	10
01364.006	ø 63 x 63 x 63	145,446	6

### art. 1365

Raccordo curvo a 90° per tubo pe - innesto  
rapido brevettato



01365.001	ø 20	12,625	30
01365.002	ø 25	18,679	24
01365.003	ø 32	28,530	20
01365.004	ø 40	35,821	10
01365.005	ø 50	50,041	8
01365.006	ø 63	107,925	4

**art. 1366** 

Raccordo curvo a 90° maschio per tubo pe  
- innesto rapido brevettato



cod. art.	mis.	€	conf.
01366.001	1/2"x20	<b>8,341</b>	20
01366.002	3/4"x25	<b>12,753</b>	20
01366.003	1"x32	<b>19,519</b>	20
01366.004	1"1/4x40	<b>29,981</b>	10
01366.005	1"1/2x50	<b>37,774</b>	10
01366.006	2"x63	<b>80,045</b>	6

**art. 1367** 

Raccordo curvo a 90° femmina per tubo pe  
- innesto rapido brevettato



01367.001	1/2"x20	<b>9,454</b>	20
01367.002	3/4"x25	<b>13,298</b>	20
01367.003	1"x32	<b>20,632</b>	12
01367.004	1"1/4x40	<b>32,354</b>	12
01367.005	1"1/2x50	<b>40,252</b>	10
01367.006	2"x63	<b>67,984</b>	5

## RACCORDI IN OTTONE PER TUBO POLIETILENE E PVC

**art. 1200**

Raccordo per tubo in polietilene e in PVC,  
maschio.



01200.001	1/2"x20	<b>5,083</b>	10
01200.002	3/4"x25	<b>6,720</b>	10
01200.003	1"x32	<b>11,199</b>	10
01200.004	1"1/4x40	<b>17,273</b>	10
01200.005	1"1/2x50	<b>27,697</b>	10
01200.006	2"x63	<b>48,287</b>	10

**art. 1201**

Raccordo per tubo in polietilene e in PVC,  
femmina.



01201.001	1/2"x20	<b>5,083</b>	10
01201.002	3/4"x25	<b>7,107</b>	10
01201.003	1"x32	<b>11,673</b>	10
01201.004	1"1/4x40	<b>17,531</b>	10
01201.005	1"1/2x50	<b>28,731</b>	10
01201.006	2"x63	<b>50,828</b>	10

**art. 1202**

Raccordo per tubo in polietilene e in PVC,  
doppio.



01202.001	1/2"x20	<b>8,658</b>	10
01202.002	3/4"x25	<b>11,673</b>	10
01202.003	1"x32	<b>17,531</b>	10
01202.004	1"1/4x40	<b>26,189</b>	10
01202.005	1"1/2x50	<b>44,711</b>	10
01202.006	2"x63	<b>80,549</b>	10

**art. 1203**

Raccordo per tubo in polietilene e in PVC,  
gomito maschio.



01203.001	1/2"x20	<b>6,590</b>	10
01203.002	3/4"x25	<b>9,390</b>	10
01203.003	1"x32	<b>14,990</b>	10
01203.004	1"1/4x40	<b>23,389</b>	10
01203.005	1"1/2x50	<b>42,687</b>	10
01203.006	2"x63	<b>74,217</b>	10

### art. 1204

Raccordo per tubo in polietilene e in PVC, gomito femmina.



cod. art.	mis.	€	conf.
01204.001	1/2"x20	6,590	10
01204.002	3/4"x25	9,390	10
01204.003	1"x32	15,248	10
01204.004	1"1/4x40	25,672	10
01204.005	1"1/2x50	45,745	10
01204.006	2"x63	74,993	10

### art. 1205

Raccordo per tubo in polietilene e in PVC, gomito doppio.

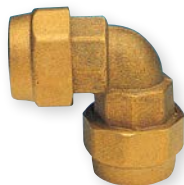

01205.001	1/2"x20	9,390	10
01205.002	3/4"x25	13,224	10
01205.003	1"x32	20,590	10
01205.004	1"1/4x40	33,555	10
01205.005	1"1/2x50	57,203	10
01205.006	2"x63	98,339	10

### art. 1206

Raccordo per tubo in polietilene e in PVC, T.E. tre dadi.



01206.001	1/2"x20	13,224	10
01206.002	3/4"x25	18,307	10
01206.003	1"x32	28,731	10
01206.004	1"1/4x40	43,979	10
01206.005	1"1/2x50	81,325	10
01206.006	2"x63	134,694	10

### art. 1207

Raccordo per tubo in polietilene e in PVC, T.E. femmina.

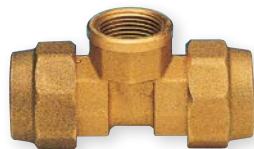

01207.001	1/2"x20	10,166	10
01207.002	3/4"x25	14,731	10
01207.003	1"x32	23,389	10
01207.004	1"1/4x40	36,872	10
01207.005	1"1/2x50	71,159	10
01207.006	2"x63	113,092	10

### art. 1208

Bussola di rinforzo per gas.



01208.001	Ø 20	1,901	10
01208.002	Ø 25	2,051	10
01208.003	Ø 32	2,151	10
01208.004	Ø.40	4,452	10
01208.005	Ø 50	6,803	10
01208.006	Ø 63	12,706	10

**art. 1170**

Raccordo maschio polietilene.

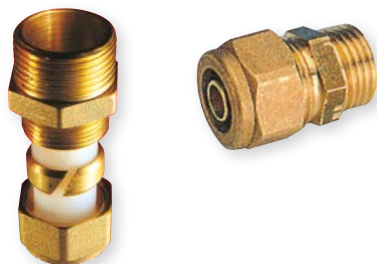

cod. art.	mis.	€	conf.
01170.004	1/2"x15x2,5	<b>4,847</b>	10
01170.006	1/2"x18x2,5	<b>6,788</b>	10
01170.007	1/2"x20x2	<b>7,473</b>	10

**art. 1171**

Raccordo femmina polietilene.



01171.004	1/2"x15x2,5	<b>5,417</b>	10
01171.006	1/2"x18x2,5	<b>7,388</b>	10
01171.007	1/2"x20x2	<b>7,988</b>	10

**art. 1172**

Raccordo doppio polietilene.



01172.002	15x2,5	<b>8,554</b>	10
01172.006	18x2,5	<b>12,721</b>	10
01172.007	20x2	<b>12,721</b>	10

**art. 1175**

Raccordo angolo femmina polietilene.



01175.004	1/2"x15x2,5	<b>6,558</b>	10
01175.006	1/2"x18x2,5	<b>8,929</b>	10
01175.007	1/2"x20x2	<b>9,299</b>	10

**art. 1176**

Raccordo TEE 3 dadi polietilene.



01176.002	15x15x15x2,5	<b>13,686</b>	10
01176.006	18x18x18x2,5	<b>17,108</b>	10
01176.007	20x20x20x2	<b>18,108</b>	10

## RACCORDI IN P.P. PER TUBO POLIETILENE

### art. 8650

Raccordo maschio per tubi polietilene.



cod. art.	mis.	€	conf.
08650.001	1/2"x20	3,401	10
08650.002	3/4"x25	3,872	10
08650.003	1"x32	4,862	10
08650.004	1"1/4x40	9,099	10
08650.005	1"1/2x50	11,875	10
08650.006	2"x63	16,882	10
08650.007	2"1/2x75	33,645	10
08650.008	3"x90	39,727	10
08650.009	4"x110	78,354	10

### art. 8651

Raccordo femmina per tubi polietilene.



08651.001	1/2"x20	3,632	10
08651.002	3/4"x25	4,237	10
08651.003	1"x32	5,347	10
08651.004	1"1/4x40	8,334	10
08651.005	1"1/2x50	11,985	10
08651.006	2"x63	16,882	10
08651.007	2"1/2x75	33,645	10
08651.008	3"x90	41,338	10
08651.009	4"x110	97,738	10

### art. 8652

Raccordo doppio per tubi polietilene.



08652.001	20x20	5,813	10
08652.002	25x25	6,953	10
08652.003	32x32	8,979	10
08652.004	40x40	14,616	10
08652.005	50x50	19,909	10
08652.006	63x63	27,567	10
08652.007	75x75	51,933	10
08652.008	90x90	64,228	10
08652.009	110x110	137,355	10

### art. 8653

Gomito maschio a 90° per tubi polietilene.



08653.001	1/2"x20	3,872	10
08653.002	3/4"x25	4,702	10
08653.003	1"x32	6,063	10
08653.004	1"1/4x40	9,719	10
08653.005	1"1/2x50	13,251	10
08653.006	2"x63	18,413	10
08653.007	2"1/2x75	38,837	10
08653.008	3"x90	48,731	10
08653.009	4"x110	94,642	10

### art. 8654

Gomito femmina a 90° per tubi polietilene.



08654.001	1/2"x20	4,357	10
08654.002	3/4"x25	5,482	10
08654.003	1"x32	6,418	10
08654.004	1"1/4x40	12,646	10
08654.005	1"1/2x50	16,882	10
08654.006	2"x63	22,990	10
08654.007	2"1/2x75	39,727	10
08654.008	3"x90	76,023	10
08654.009	4"x110	125,160	10

### art. 8655

Gomito doppio per tubi polietilene.



08655.001	20x20	5,813	10
08655.002	25x25	7,063	10
08655.003	32x32	8,824	10
08655.004	40x40	15,317	10
08655.005	50x50	21,424	10
08655.006	63x63	25,991	10
08655.007	75x75	50,447	10
08655.008	90x90	62,578	10
08655.009	110x110	129,672	10

**art. 8656**

Tee filettato femmina per tubi polietilene.

**art. 8657**

Tee filettato maschio per tubi polietilene.

**art. 8658**

Tee a tre dadi per tubi polietilene.

**art. 8659**

Tappo fine linea per tubi polietilene.

**art. 8660**

Presa a staffa per tubi polietilene.



cod. art.	mis.	€	conf.
08656.001	1/2"x20	6,063	10
08656.002	3/4"x25	7,713	10
08656.003	1"x32	10,049	10
08656.004	1"1/4x40	18,463	10
08656.005	1"1/2x50	24,456	10
08656.006	2"x63	35,130	10
08656.007	2"1/2x75	57,986	10
08656.008	3"x90	90,055	10
08656.009	4"x110	135,900	10
08657.001	1/2"x20	6,418	10
08657.002	3/4"x25	8,329	10
08657.003	1"x32	10,465	10
08657.004	1"1/4x40	18,413	10
08657.005	1"1/2x50	25,996	10
08657.006	2"x63	50,447	10
08657.007	2"1/2x75	62,688	10
08657.008	3"x90	91,385	10
08657.009	4"x110	150,141	10
08658.001	20x20x20	7,613	10
08658.002	25x25x25	10,049	10
08658.003	32x32x32	13,021	10
08658.004	40x40x40	21,424	10
08658.005	50x50x50	29,043	10
08658.006	63x63x63	43,139	10
08658.007	75x75x75	71,742	10
08658.008	90x90x90	99,224	10
08658.009	110x110x110	193,225	10
08659.001	20	3,922	10
08659.002	25	4,362	10
08659.003	32	5,352	10
08659.004	40	8,984	10
08659.005	50	13,251	10
08659.006	63	17,993	10
08659.007	75	42,799	10
08659.008	90	48,851	10
08659.009	110	105,341	10
08660.002	1/2"x25	1,834	10
08660.003	1/2"x32	2,418	10
08660.004	1/2"x40	6,318	10
08660.005	1/2"x50	6,864	10
08660.008	3/4"x25	1,834	10
08660.009	3/4"x32	2,418	10
08660.010	3/4"x40	2,876	10
08660.011	3/4"x50	3,196	10
08660.016	1"x40	2,876	10
08660.017	1"x50	3,196	10
08660.018	1"x63	4,356	10
08660.019	1"x75	6,037	10
08660.020	1"x90	6,927	10
08660.022	1"1/4x63	4,356	10
08660.023	1"1/4x75	6,037	10
08660.024	1"1/4x90	6,927	10
08660.025	1"1/4x110	8,177	10
08660.026	1"1/2x75	6,037	10
08660.027	1"1/2x90	6,927	10
08660.028	1"1/2x110	8,177	10

**art. 8662**

Tee ridotto



cod. art.	mis.	€	conf.
08662.001	25x20x25 mm	<b>9,819</b>	10
08662.002	32x20x32 mm	<b>12,646</b>	10
08662.003	32x25x32 mm	<b>12,646</b>	10
08662.004	40x25x40 mm	<b>21,429</b>	10
08662.005	40x32x40 mm	<b>21,429</b>	10
08662.006	50x25x50 mm	<b>29,043</b>	10
08662.007	50x32x50 mm	<b>29,043</b>	10
08662.008	50x40x50 mm	<b>29,043</b>	10
08662.009	63x25x63 mm	<b>38,232</b>	10
08662.010	63x32x63 mm	<b>38,232</b>	10
08662.011	63x40x63 mm	<b>38,232</b>	10
08662.012	63x50x63 mm	<b>38,232</b>	10
08662.013	75x50x75 mm	<b>71,742</b>	10
08662.014	75x63x75 mm	<b>71,742</b>	10
08662.015	90x63x90 mm	<b>103,150</b>	10
08662.016	90x75x90 mm	<b>103,150</b>	10
08662.017	110x75x110 mm	<b>206,266</b>	10
08662.018	110x90x110 mm	<b>206,266</b>	10

**art. 8663**

Manicotto riparazione



08663.001	25x25 mm	<b>8,289</b>	10
08663.002	32x32 mm	<b>10,700</b>	10
08663.003	40x40 mm	<b>17,403</b>	10
08663.004	50x50 mm	<b>23,916</b>	10
08663.005	63x63 mm	<b>31,629</b>	10
08663.006	75x75 mm	<b>60,472</b>	10
08663.007	90x90 mm	<b>76,969</b>	10
08663.008	110x110 mm	<b>157,714</b>	10

**art. 8661**Tubo in rotoli in Polipropilene PN16-PE100  
AD Rotolo da 100 mt.

08661.020	Ø20	<b>1,867</b>	100
08661.025	Ø25	<b>2,818</b>	100
08661.032	Ø32	<b>4,381</b>	100



**art. 1210**

Curva 90° MF.  
In rame a saldare.  
1/R



cod. art.	mis.	€	conf.
01210.001	Ø 10	<b>2,318</b>	10
01210.002	Ø 12	<b>1,451</b>	10
01210.003	Ø 14	<b>2,201</b>	10
01210.004	Ø 16	<b>2,084</b>	10
01210.005	Ø 18	<b>3,051</b>	10
01210.006	Ø 22	<b>4,235</b>	10
01210.007	Ø 28	<b>6,836</b>	10
01210.008	Ø 35	<b>16,324</b>	10
01210.009	Ø 42	<b>25,561</b>	10
01210.010	Ø 54	<b>45,353</b>	10

**art. 1211**

Curva 90° FF.  
In rame a saldare.  
2/R



01211.001	Ø 10	<b>1,517</b>	10
01211.002	Ø 12	<b>1,301</b>	10
01211.003	Ø 14	<b>1,901</b>	10
01211.004	Ø 16	<b>2,001</b>	10
01211.005	Ø 18	<b>2,501</b>	10
01211.006	Ø 22	<b>4,235</b>	10
01211.007	Ø 28	<b>6,653</b>	10
01211.008	Ø 35	<b>16,441</b>	10
01211.009	Ø 42	<b>28,479</b>	10
01211.010	Ø 54	<b>43,219</b>	10

**art. 1212**

Gomito 45° MF.  
In rame a saldare.  
40/R



01212.001	Ø 10	<b>2,434</b>	10
01212.002	Ø 12	<b>2,201</b>	10
01212.003	Ø 14	<b>1,584</b>	10
01212.004	Ø 16	<b>1,584</b>	10
01212.005	Ø 18	<b>2,084</b>	10
01212.006	Ø 22	<b>3,552</b>	10
01212.007	Ø 28	<b>5,136</b>	10
01212.008	Ø 35	<b>12,939</b>	10
01212.009	Ø 42	<b>18,291</b>	10
01212.010	Ø 54	<b>34,115</b>	10

**art. 1213**

Gomito 45° FF.  
In rame a saldare.  
41/R



01213.001	Ø 10	<b>2,434</b>	10
01213.002	Ø 12	<b>1,534</b>	10
01213.003	Ø 14	<b>1,584</b>	10
01213.004	Ø 16	<b>1,584</b>	10
01213.005	Ø 18	<b>1,918</b>	10
01213.006	Ø 22	<b>3,552</b>	10
01213.007	Ø 28	<b>4,902</b>	10
01213.008	Ø 35	<b>13,406</b>	10
01213.009	Ø 42	<b>18,291</b>	10
01213.010	Ø 54	<b>33,098</b>	10

**art. 1214**

Gomito 90° FF.  
In rame a saldare.  
90/R



01214.001	Ø 10	<b>1,584</b>	10
01214.002	Ø 12	<b>1,534</b>	10
01214.003	Ø 14	<b>1,534</b>	10
01214.004	Ø 16	<b>1,951</b>	10
01214.005	Ø 18	<b>2,318</b>	10
01214.006	Ø 22	<b>3,435</b>	10
01214.007	Ø 28	<b>5,152</b>	10
01214.008	Ø 35	<b>13,856</b>	10
01214.009	Ø 42	<b>19,709</b>	10
01214.010	Ø 54	<b>39,284</b>	10

**art. 1215**

Gomito 90° MF.  
In rame a saldare.  
92/R



cod. art.	mis.	€	conf.
01215.001	Ø 10	1,534	10
01215.002	Ø 12	2,084	10
01215.003	Ø 14	1,801	10
01215.004	Ø 16	2,001	10
01215.005	Ø 18	2,318	10
01215.006	Ø 22	3,552	10
01215.007	Ø 28	5,352	10
01215.008	Ø 35	15,357	10
01215.009	Ø 42	20,659	10
01215.010	Ø 54	37,650	10

**art. 1216**

TEE F.  
In rame a saldare.  
130/R

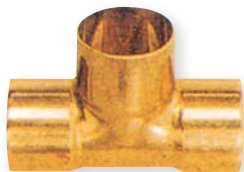

01216.001	Ø 10	2,901	10
01216.002	Ø 12	2,251	10
01216.003	Ø 14	2,201	10
01216.004	Ø 16	2,735	10
01216.005	Ø 18	4,165	10
01216.006	Ø 22	5,319	10
01216.007	Ø 28	9,287	10
01216.008	Ø 35	23,327	10
01216.009	Ø 42	33,948	10
01216.010	Ø 54	58,426	10

**10****art. 1216R**

TEE ridotto.  
In rame a saldare.  
130/RR

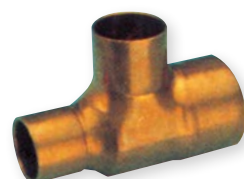

1216R.001	10-12-10	5,236	10
1216R.002	12-10-10	4,335	10
1216R.003	12-10-12	4,235	10
1216R.004	12-12-10	3,785	10
1216R.005	12-14-12	3,552	10
1216R.006	12-16-12	4,285	10
1216R.008	14-12-12	4,169	10
1216R.009	14-12-14	3,051	10
1216R.011	14-14-12	4,118	10
1216R.012	14-16-14	3,051	10
1216R.013	14-18-14	5,136	10
1216R.015	16-12-12	4,452	10
1216R.017	16-12-16	2,818	10
1216R.019	16-14-14	4,118	10
1216R.020	16-14-16	3,785	10
1216R.021	16-16-12	5,069	10
1216R.022	16-16-14	4,169	10
1216R.023	16-18-16	6,536	10
1216R.024	16-22-16	7,153	10
1216R.028	18-14-14	5,803	10
1216R.029	18-14-18	3,835	10
1216R.030	18-16-16	4,169	10
1216R.031	18-16-18	3,952	10
1216R.032	18-18-12	5,686	10
1216R.033	18-18-14	5,236	10
1216R.034	18-22-18	6,986	10
1216R.035	22-12-22	4,952	10
1216R.036	22-14-14	7,036	10

**art. 1216R**

TEE ridotto.  
In rame a saldare.  
130/RR



cod. art.	mis.	€	conf.
1216R.039	22-16-16	7,153	10
1216R.040	22-16-22	4,452	10
1216R.041	22-18-18	8,554	10
1216R.042	22-18-22	5,136	10
1216R.044	22-22-16	8,454	10
1216R.045	22-22-18	8,904	10
1216R.049	28-18-18	10,138	10
1216R.051	28-18-28	9,904	10
1216R.053	28-22-22	10,471	10
1216R.054	28-22-28	8,454	10
1216R.056	35-22-35	18,742	10
1216R.057	35-28-35	19,475	10
1216R.058	42-28-42	28,029	10
1216R.059	42-35-42	31,797	10
1216R.060	54-42-54	54,757	10

**art. 1217**

Manicotto FF.  
In rame a saldare.  
270R



01217.001	Ø 10	0,634	10
01217.002	Ø 12	0,734	10
01217.003	Ø 14	0,900	10
01217.004	Ø 16	1,184	10
01217.005	Ø 18	1,301	10
01217.006	Ø 22	2,001	10
01217.007	Ø 28	3,101	10
01217.008	Ø 35	6,169	10
01217.009	Ø 42	10,988	10
01217.010	Ø 54	16,324	10

**art. 1225**

Raccordo con dado ottone.  
In rame a saldare.  
359/FR

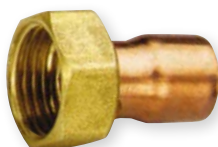

01225.001	3/8x12	3,235	10
01225.002	1/2x12	3,785	10
01225.003	1/2x14	6,870	10
01225.004	1/2x15	3,251	10
01225.005	1/2x16	5,919	10
01225.006	3/4x14	3,586	10
01225.007	3/4x15	5,219	10
01225.008	3/4x16	5,519	10
01225.009	3/4x18	4,802	10
01225.010	3/4x22	5,319	10
01225.011	1"x22	16,441	11

**art. 1220**

Manicotto MF. Bronzo.  
243/R



01220.001	3/8"x10	3,268	10
01220.002	3/8"x12	4,569	10
01220.003	1/2"x10	4,452	10
01220.004	1/2"x12	3,885	10
01220.005	1/2"x14	3,151	10
01220.006	1/2"x16	3,839	10
01220.007	1/2"x18	4,052	10
01220.008	1/2"x22	6,870	10
01220.010	3/4"x16	5,519	10
01220.011	3/4"x18	5,019	10
01220.012	3/4"x22	3,435	10
01220.013	3/4"x28	11,939	10
01220.014	1"x22	8,220	10
01220.015	1"x28	8,337	10
01220.016	1"x35	17,624	10
01220.017	1"1/4x35	14,240	10

**art. 1221**Manicotto FF. Bronzo.  
270/FR

cod. art.	mis.	€	conf.
01221.001	3/8"x10	8,287	10
01221.002	3/8"x12	3,268	10
01221.003	1/2"x10	8,507	10
01221.004	1/2"x12	6,203	10
01221.005	1/2"x14	4,052	10
01221.006	1/2"x16	4,052	10
01221.007	1/2"x18	4,169	10
01221.008	1/2"x22	9,004	10
01221.009	3/4"x14	11,472	10
01221.010	3/4"x16	7,437	10
01221.011	3/4"x18	6,253	10
01221.012	3/4"x22	8,337	10
01221.013	3/4"x28	8,054	10
01221.014	1"x22	12,055	10
01221.015	1"x28	12,722	10
01221.016	1"x35	15,590	10
01221.017	1"1/4x35	22,060	10

**art. 1222**Gomito MF. Bronzo.  
92/FR

01222.004	1/2"x12	6,369	10
01222.005	1/2"x14	7,203	10
01222.006	1/2"x16	8,504	10
01222.007	1/2"x18	7,153	10
01222.008	3/4"x22	11,438	10
01222.009	3/4"x28	20,042	10
01222.010	1"x22	18,408	10
01222.011	1"x28	18,575	10

**art. 1223**Gomito FF. Bronzo.  
90/FR

01223.004	1/2"x12	6,203	10
01223.005	1/2"x14	6,486	10
01223.006	1/2"x16	6,870	10
01223.007	1/2"x18	6,986	10
01223.008	1/2"x22	10,805	10
01223.010	3/4"x16	9,571	10
01223.011	3/4"x18	9,521	10
01223.012	3/4"x22	11,255	10
01223.013	3/4"x28	13,956	10
01223.014	1"x22	16,324	10
01223.015	1"x28	25,211	10
01223.016	1"x35	a richiesta	10

**art. 1224**TEE F. Bronzo.  
130/FR

01224.003	1/2"X10	a richiesta	10
01224.004	1/2"X12	a richiesta	10
01224.005	1/2"X14	a richiesta	10
01224.006	1/2"X16	a richiesta	10
01224.007	1/2"X18	a richiesta	10
01224.008	1/2"X22	a richiesta	10
01224.009	3/4"X16	a richiesta	10
01224.010	3/4"X18	a richiesta	10
01224.011	3/4"X22	a richiesta	10
01224.012	3/4"X28	a richiesta	10
01224.013	1"X28	a richiesta	10

# Raccordo in ottone nichelato per riparazione tubi ferro per acqua - gas

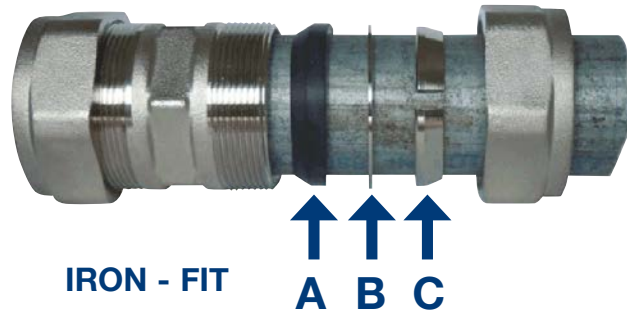

Questi raccordi di riparazione realizzati in ottone UNI EN12165 CW617N-DW stampato a caldo e successivamente nichelati, sono adatti al serraggio del tubo in ferro zincato in impianti **acqua e gas**.

La tenuta meccanica è garantita da un anello conico dentato e tagliato [ **C** ] mentre la tenuta idraulica è garantita da una guarnizione tronco conica in NBR 70 Sh. [ **A** ] unita ad una rondella in ottone cromata [ **B** ]. I filetti sono conici a tenuta su filetto di tipo R e RP conformi allo standard UNI-ISO 7-1-1994/CUR 1:2007.

misura	DN	liquido PN	gas PN	lunghezza di taglio del tubo	
				minimo	massimo
3/8	10	50	4	16	37
1/2	15	50	4	16	37
3/4	20	50	4	16	37
1"	25	50	4	16	37
1"1/4	32	32	4	18	37
1"1/2	40	32	4	18	37
2"	50	25	4	18	37

## art. 1230

Raccordo maschio lungo.



cod. art.	mis.	€	conf.
01230.001	3/8"	10,588	10
01230.002	1/2"	13,047	10
01230.003	3/4"	16,007	10
01230.004	1"	23,385	10
01230.005	1"1/4	36,891	10
01230.006	1"1/2	41,810	10
01230.007	2"	63,945	10

## art. 1231

Raccordo intermedio lungo.

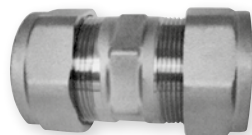

01231.001	3/8"	18,466	10
01231.002	1/2"	21,134	10
01231.003	3/4"	24,594	10
01231.004	1"	34,432	10
01231.005	1"1/4	51,648	10
01231.006	1"1/2	59,026	10
01231.007	2"	93,458	10

## art. 1232

Raccordo femmina lungo.



01232.001	3/8"	10,588	10
01232.002	1/2"	13,047	10
01232.003	3/4"	16,007	10
01232.004	1"	23,385	10
01232.005	1"1/4	36,891	10
01232.006	1"1/2	41,810	10
01232.007	2"	63,945	10

# Raccordo in ottone a compressione per tubo rame tenuta o-ring NBR per acqua - gas

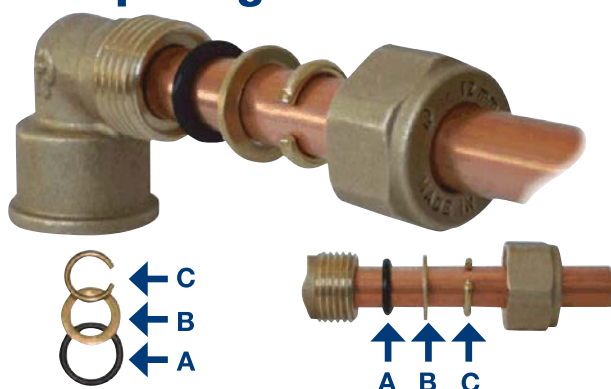

Raccordi a compressione conformi alle norme UNI EN1254-2:2000 e UNI EN1254-4:2000 realizzati in ottone UNI EN12165 CW617N stampato a caldo adatti al serraggio del tubo di rame nei sistemi idraulici per acqua. La tenuta idraulica è garantita da un O-Ring in NBR 70 Sh. [ A ] con omologazione DVGW secondo norma DIN EN549 B2 (-20°/+80°C), H3 unita ad una rondella [ B ] in ottone UNI EN1652 e ad un anello elastico [ C ] in ottone UNI EN12166-Cu-ETP. Le filettature sono coniche a tenuta su filetto di tipo R ed Rp e conformi allo Standard UNI ISO 7-1:1994/Cor 1:2007.

## art. 1235

Raccordo diritto con attacco maschio.



cod. art.	mis.	€	conf.
01235.001	3/8"x10	3,585	10
01235.002	3/8"x12	4,169	10
01235.005	1/2"x10	3,918	10
01235.006	1/2"x12	4,294	10
01235.007	1/2"x14	5,169	10
01235.008	1/2"x16	6,503	10
01235.009	1/2"x18	6,628	10
01235.010	3/4"x14	6,628	10
01235.011	3/4"x16	7,378	10
01235.012	3/4"x18	7,003	10
01235.013	3/4"x22	9,838	10
01235.014	1"x18	9,838	10
01235.015	1"x22	11,088	10
01235.016	1"x28	14,256	10

## art. 1236

Raccordo diritto con attacco femmina.



01236.001	3/8"x10	4,419	10
01236.005	1/2"x10	4,294	10
01236.006	1/2"x12	4,669	10
01236.007	1/2"x14	6,253	10
01236.008	1/2"x16	7,128	10
01236.009	1/2"x18	7,128	10
01236.010	3/4"x14	7,003	10
01236.011	3/4"x16	7,378	10
01236.012	3/4"x18	7,378	10
01236.013	3/4"x22	10,463	10
01236.014	1"x22	11,797	10

## art. 1237

Raccordo diritto intermedio.



01237.001	Ø 10	5,294	10
01237.002	Ø 12	6,628	10
01237.003	Ø 14	8,129	10
01237.004	Ø 16	9,838	10
01237.005	Ø 18	9,838	10
01237.006	Ø 22	15,007	10
01237.007	Ø 28	19,425	10

**art. 1238**  
Raccordo a tee.



cod. art.	mis.	€	conf.
01238.001	Ø 10	<b>8,837</b>	10
01238.002	Ø 12	<b>11,547</b>	10
01238.003	Ø 14	<b>12,547</b>	10
01238.004	Ø 10	<b>14,006</b>	10
01238.005	Ø 18	<b>14,006</b>	10
01238.006	Ø 22	<b>21,134</b>	10

**art. 1240**  
Tee femmina.



01240.003	1/2"x12	<b>9,337</b>	10
01240.004	1/2"x14	<b>10,088</b>	10
01240.005	1/2"x16	<b>11,297</b>	10
01240.006	1/2"x18	<b>10,713</b>	10
01240.007	3/4"x16	<b>12,297</b>	10
01240.008	3/4"x18	<b>12,297</b>	10
01240.009	3/4"x22	<b>20,176</b>	10

**art. 1241**  
Raccordo a gomito.



01241.001	Ø 10	<b>6,628</b>	10
01241.002	Ø 12	<b>8,629</b>	10
01241.003	Ø 14	<b>9,087</b>	10
01241.004	Ø 16	<b>10,338</b>	10
01241.005	Ø 18	<b>10,088</b>	10
01241.006	Ø 22	<b>15,007</b>	10

**art. 1242**  
Gomito femmina.



01242.003	1/2"x10	<b>5,544</b>	10
01242.004	1/2"x12	<b>5,794</b>	10
01242.005	1/2"x14	<b>6,169</b>	10
01242.006	1/2"x16	<b>6,878</b>	10
01242.007	1/2"x18	<b>6,878</b>	10
01242.008	3/4"x14	<b>8,129</b>	10
01242.009	3/4"x16	<b>8,504</b>	10
01242.010	3/4"x18	<b>8,629</b>	10
01242.011	3/4"x22	<b>11,088</b>	10

**art. 1243**  
Gomito maschio.



01243.002	1/2"x10	<b>5,919</b>	10
01243.003	1/2"x12	<b>5,919</b>	10
01243.004	1/2"x14	<b>6,878</b>	10
01243.005	1/2"x16	<b>7,128</b>	10
01243.006	1/2"x18	<b>6,878</b>	10
01243.007	3/4"x14	<b>7,878</b>	10
01243.008	3/4"x16	<b>8,379</b>	10
01243.009	3/4"x18	<b>8,629</b>	10
01243.010	3/4"x22	<b>11,297</b>	10

**art. 1244**  
Gomito con flangia.



01244.002	1/2"x12	<b>7,378</b>	10
01244.003	1/2"x14	<b>8,379</b>	10
01244.004	1/2"x16	<b>8,629</b>	10

### art. 1246

Kit ACQUA per tenuta tubo RAME  
O-Ring NBR + anello + Ranella



cod. art.	mis.	€	conf.
01246.001	Ø 10	0,409	10
01246.002	Ø 12	0,496	10
01246.003	Ø 14	0,563	10
01246.004	Ø 16	0,609	10
01246.005	Ø 18	0,746	10
01246.006	Ø 22	1,084	10
01246.007	Ø 28	1,622	10

### art. 1247

Kit GAS per tubo RAME  
Anello tronco - conico in ottone + O-Ring  
HNBR



01247.001	Ø 10	0,584	10
01247.002	Ø 12	0,750	10
01247.003	Ø 14	0,875	10
01247.004	Ø 16	1,000	10
01247.005	Ø 18	1,167	10
01247.006	Ø 22	1,834	10
01247.007	Ø 28	2,251	10

### art. 7880

RACCORDI PER MULTISTRATO MULTI -  
FIT® ITAP

Multo-Fit® è un sistema la cui base è costituita dal raccordo con dado femmina art. 830 che può essere usato da solo, oppure insieme alla linea di raccordi Multo-Fit®, formando così una gamma di combinazioni adeguate ad ogni esigenza d'installazione. Il raccordo Multo-Fit® è particolarmente adatto all'uso insieme alla linea di valvole e detentori per radiatore e ai collettori ITAP.



#### CON DADO 1/2" GAS

07880.001	14X2	4,966	20
07880.003	16X2	5,061	20
07880.006	18X2	5,488	15
07880.008	20X2	5,776	15
07880.009	20X2,25	5,776	15
07880.010	20X2,5	5,539	15

#### CON DADO 3/4" ADATTO EUROKONU

07880.013	16X2	6,147	20
07880.016	18X2	6,728	15
07880.018	20X2	6,478	15
07880.019	20X2,25	6,461	15
07880.021	25X2,5	8,279	10
07880.022	26X3	8,279	10

#### CON DADO 1"

07880.023	25X2,5	12,974	10
07880.024	26X3	12,974	10
07880.025	32X3	15,701	10





**art. 1965**

Tubo multistrato nudo in rotoli.



cod. art.	mis.	€	conf.
01965.001	16x2.00	<b>2,344</b>	100
01965.003	20x2.00	<b>3,267</b>	100
01965.004	26x3.00	<b>5,967</b>	50
01965.005	32x3.00	<b>8,240</b>	25

**art. 1966**

Tubo multistrato c/guaina isolante bianca in rotoli.



01966.001	16x2.00	<b>2,510</b>	50
01966.003	20x2.00	<b>3,559</b>	50
01966.004	26x3.00	<b>7,095</b>	50
01966.005	32x3.00	<b>12,359</b>	50

**art. 1966B**

Tubo multistrato c/guaina isolante blu in rotoli.



1966B.001	Ø 16	<b>2,510</b>	50
1966B.002	Ø 20	<b>3,559</b>	50

**art. 1966R**

Tubo multistrato c/guaina isolante rossa in rotoli.



1966R.001	Ø 16	<b>2,510</b>	50
1966R.002	Ø 20	<b>3,559</b>	50

### art. 1920

Raccordo per multistrato a pressare diritto maschio.



cod. art.	mis.	€	conf.
01920.001	1/2x16x2	4,617	10
01920.003	1/2x20x2	5,256	10
01920.005	3/4x20x2	6,251	10
01920.007	3/4x26x3	8,311	10
01920.009	1"x26x3	9,802	10
01920.010	1"x32x3	11,933	10

### art. 1921

Raccordo per multistrato a pressare diritto femmina.



01921.001	1/2x16x2	4,901	10
01921.003	1/2x20x2	5,327	10
01921.005	3/4x20x2	6,819	10
01921.007	3/4x26x3	8,524	10
01921.009	1"x26x3	11,365	10
01921.010	1"x32x3	12,644	10

### art. 1921G

Raccordo diritto femmina.  
Dado girevole.



1921G.001	1/2x16x2	7,813	10
1921G.002	1/2x20x2	11,483	10
1921G.005	3/4x20x2	13,891	10

### art. 1922

Raccordo per multistrato a pressare diritto intermedio.



01922.001	16x16x2	4,404	10
01922.003	20x20x2	5,754	10
01922.005	26x26x3	9,092	10
01922.006	32x32x3	14,490	10

### art. 1923

Raccordo per multistrato a pressare diritto intermedio ridotto.



01923.001	2x20x16x2	5,329	10
01923.004	3x26x20x2	8,311	10
01923.006	3x32x26x3	12,928	10

### art. 1924

Raccordo per multistrato a pressare TE uguale.



01924.001	16x16x16x2	7,955	10
01924.003	20x20x20x2	10,513	10
01924.005	26x26x26x3	17,545	10
01924.006	32x32x32x3	29,123	10

### art. 1925

Raccordo per multistrato a pressare tee ridotto.



01925.003	20x16x16	7,687	10
01925.004	20x16x20	10,086	10
01925.007	20x20x16	11,649	10
01925.009	20x26x20	14,234	10
01925.025	32x20x32	20,362	10
01925.027	32x26x26	17,703	10
01925.028	32x26x32	22,335	10

### art. 1926

Raccordo per multistrato a pressare tee femmina.



01926.001	16x1/2x16	8,169	10
01926.003	20x1/2x20	10,513	10
01926.004	20x3/4x20	12,212	10
01926.006	26x3/4x26	17,047	10
01926.007	32x1"x32	29,407	10

**art. 1929**

Raccordo per multistrato a pressare a gomito.



cod. art.	mis.	€	conf.
01929.001	16x16x2	<b>6,109</b>	10
01929.003	20x20x2	<b>7,671</b>	10
01929.005	26x26x3	<b>8,697</b>	10
01929.006	32x32x3	<b>19,889</b>	10

**art. 1930**

Gomito per multistrato a pressare femmina.



01930.001	1/2x16x2	<b>5,896</b>	10
01930.003	1/2x20x2	<b>7,245</b>	10
01930.004	3/4x20x2	<b>9,092</b>	10
01930.006	3/4x26x3	<b>11,223</b>	10
01930.007	1"x32x3	<b>20,173</b>	10

**art. 1931**

Gomito per multistrato a pressare maschio.



01931.001	1/2x16x2	<b>5,967</b>	10
01931.003	1/2x20x2	<b>7,032</b>	10
01931.004	3/4x20x2	<b>8,950</b>	10
01931.006	3/4x26x3	<b>11,152</b>	10
01931.007	1"x32x3	<b>20,031</b>	10

**art. 1932**

Gomito per multistrato a pressare con flangia.



01932.001	1/2x16x2	<b>8,328</b>	10
01932.003	1/2x20x2	<b>10,015</b>	10

**N.B. A RICHIESTA ALTRE FIGURE**

### art. 1950

Raccordo per multistrato a stringere diritto maschio.



cod. art.	mis.	€	conf.
01950.004	1/2x16	3,527	10
01950.006	1/2x20	5,552	10
01950.008	3/4x20	6,228	10
01950.010	3/4x26	9,229	10
01950.012	1"x26	9,379	10

### art. 1951

Raccordo per multistrato a stringere diritto femmina.



01951.004	1/2x16	3,827	10
01951.006	1/2x20	5,853	10
01951.008	3/4x20	6,453	10
01951.010	3/4x26	9,454	10
01951.012	1"x26	10,655	10

### art. 1952

Raccordo per multistrato a stringere diritto intermedio.



01952.002	16x16	5,928	10
01952.004	20x20	9,304	10
01952.006	26x26	16,507	10

### art. 1953

Raccordo per multistrato a stringere tee.



01953.002	16x16x16	10,054	10
01953.004	20x20x20	17,408	10
01953.006	26x26x26	25,061	10

### art. 1955

Raccordo per multistrato a stringere tee femmina.



01955.002	1/2x16	9,829	10
01955.004	1/2x20	14,106	10
01955.006	3/4x20	15,607	10
01955.008	3/4x26	24,461	10

### art. 1956

Raccordo per multistrato a stringere tee maschio.



01956.002	1/2x16	12,455	10
01956.004	1/2x20	17,708	10
01956.006	3/4x20	20,559	10
01956.008	3/4x26	29,413	10

### art. 1957

Raccordo per multistrato a stringere a gomito.

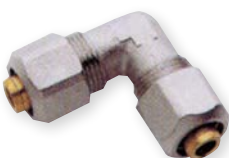

01957.002	16x16	7,203	10
01957.004	20x20	12,606	10
01957.005	26x26	17,708	10

**art. 1958**

Gomito per multistrato a stringere femmina.



cod. art.	mis.	€	conf.
01958.002	1/2x16	<b>6,753</b>	10
01958.004	1/2x20	<b>9,004</b>	10
01958.006	3/4x20	<b>9,754</b>	10
01958.008	3/4x26	<b>14,106</b>	10

**art. 1959**

Gomito per multistrato a stringere maschio.



01959.002	1/2x16	<b>5,327</b>	10
01959.004	1/2x20	<b>8,404</b>	10
01959.006	3/4x20	<b>9,004</b>	10
01959.008	3/4x26	<b>12,606</b>	10

**art. 1960**

Gomito per multistrato a stringere con flangia.



01960.002	1/2x16	<b>7,853</b>	10
01960.004	1/2x20	<b>9,004</b>	10

**art. 1961**

Gomito doppio per multistrato a stringere con flangia.



01961.002	1/2x16	<b>11,797</b>	10
-----------	--------	---------------	----

art. **1974**

Pinze.



cod. art.	mis.	€	conf.
01974.001	16	<b>386,970</b>	1
01974.003	20	<b>386,970</b>	1
01974.004	26	<b>420,785</b>	1
01974.005	32	<b>488,015</b>	1

art. **1976**

Molla curvatubi.



01976.001	16	<b>9,865</b>	1
01976.003	20	<b>15,340</b>	1

art. **1975**

Alesatore per interni ed esterni per tubi sino a Ø 40.



01975.000		<b>14,606</b>	1
-----------	--	---------------	---

10

art. **1978**

Calibratore per tubi multistrato. Ø 14 - 16 - 18 - 20 - 26 - 32



01978.000		<b>11,072</b>	1
-----------	--	---------------	---

art. **1977**

Cesoia tagliatubo sino a Ø 42.



01977.000		<b>17,163</b>	1
-----------	--	---------------	---

art. **8716**

Tagliatubi mini per rame da Ø 3 a 22 mm

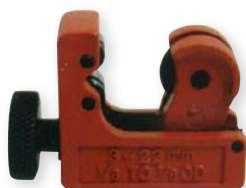

08716.000		<b>14,718</b>	1
-----------	--	---------------	---



BAMPI

art. **8730**

Tubo stratificato con 1 bicchiere in P.P.H.T.



cod. art.	mis.	€	conf.
08730.016	Ø32 x 25 cm	<b>2,095</b>	20
08730.017	Ø32 x 50 cm	<b>3,278</b>	20
08730.018	Ø32 x 100 cm	<b>5,153</b>	10
08730.019	Ø32 x 150 cm	<b>7,536</b>	10
08730.020	Ø32 x 200 cm	<b>9,682</b>	10
08730.001	Ø40 x 25 cm	<b>2,044</b>	20
08730.002	Ø40 x 50 cm	<b>2,906</b>	20
08730.003	Ø40 x 100 cm	<b>4,427</b>	10
08730.004	Ø40 x 150 cm	<b>6,623</b>	10
08730.005	Ø40 x 200 cm	<b>8,617</b>	10
08730.021	Ø50 x 50 cm	<b>3,582</b>	20
08730.022	Ø50 x 100 cm	<b>5,660</b>	10
08730.023	Ø50 x 150 cm	<b>9,124</b>	10
08730.024	Ø50 x 200 cm	<b>10,898</b>	10
08730.006	Ø90 x 25 cm	<b>5,660</b>	20
08730.007	Ø90 x 50 cm	<b>9,040</b>	10
08730.008	Ø90 x 100 cm	<b>14,531</b>	4
08730.009	Ø90 x 150 cm	<b>20,191</b>	4
08730.010	Ø90 x 200 cm	<b>27,372</b>	4
08730.011	Ø110 x 25 cm	<b>6,505</b>	20
08730.012	Ø110 x 50 cm	<b>10,391</b>	10
08730.013	Ø110 x 100 cm	<b>15,967</b>	4
08730.014	Ø110 x 150 cm	<b>23,993</b>	4
08730.015	Ø110 x 200 cm	<b>30,751</b>	4

**A RICHIESTA ALTRE MISURE**

art. **8731**

Tubo stratificato con 2 bicchieri in P.P.H.T.



08731.013	Ø32 x 50 cm	<b>4,646</b>	20
08731.014	Ø32 x 100 cm	<b>6,167</b>	10
08731.015	Ø32 x 150 cm	<b>9,546</b>	10
08731.016	Ø32 x 200 cm	<b>11,321</b>	10
08731.001	Ø40 x 50 cm	<b>3,802</b>	20
08731.002	Ø40 x 100 cm	<b>5,576</b>	10
08731.003	Ø40 x 150 cm	<b>8,276</b>	10
08731.004	Ø40 x 200 cm	<b>9,372</b>	10
08731.021	Ø50 x 50 cm	<b>4,731</b>	20
08731.022	Ø50 x 100 cm	<b>6,759</b>	10
08731.023	Ø50 x 150 cm	<b>10,729</b>	10
08731.024	Ø50 x 200 cm	<b>12,841</b>	10
08731.005	Ø90 x 50 cm	<b>12,030</b>	10
08731.006	Ø90 x 100 cm	<b>17,741</b>	10
08731.007	Ø90 x 150 cm	<b>24,922</b>	10
08731.008	Ø90 x 200 cm	<b>31,258</b>	10
08731.009	Ø110 x 50 cm	<b>13,939</b>	10
08731.010	Ø110 x 100 cm	<b>19,769</b>	10
08731.011	Ø110 x 150 cm	<b>28,724</b>	10
08731.012	Ø110 x 200 cm	<b>36,665</b>	10

**A RICHIESTA ALTRE MISURE**

art. **8732**  
Curva in P.P.H.T.



cod. art.	mis.	€	conf.
08732.016	Ø32 x 15°	1,521	50
08732.017	Ø32 x 30°	1,521	50
08732.018	Ø32 x 45°	1,521	50
08732.019	Ø32 x 67 <sup>1</sup> / <sub>2</sub> °	1,605	50
08732.020	Ø32 x 87 <sup>1</sup> / <sub>2</sub> °	1,521	50
08732.001	Ø40 x 15°	1,436	20
08732.002	Ø40 x 30°	1,436	20
08732.003	Ø40 x 45°	1,394	20
08732.004	Ø40 x 67 <sup>1</sup> / <sub>2</sub> °	1,521	20
08732.005	Ø40 x 87 <sup>1</sup> / <sub>2</sub> °	1,394	20
08732.021	Ø50 x 15°	1,825	20
08732.022	Ø50 x 30°	1,825	20
08732.023	Ø50 x 45°	1,723	20
08732.024	Ø50 x 67 <sup>1</sup> / <sub>2</sub> °	2,163	20
08732.025	Ø50 x 87 <sup>1</sup> / <sub>2</sub> °	1,723	20
08732.006	Ø90 x 15°	4,900	20
08732.007	Ø90 x 30°	4,900	20
08732.008	Ø90 x 45°	4,731	20
08732.009	Ø90 x 67 <sup>1</sup> / <sub>2</sub> °	5,153	20
08732.010	Ø90 x 87 <sup>1</sup> / <sub>2</sub> °	4,731	20
08732.011	Ø110 x 15°	5,660	20
08732.012	Ø110 x 30°	5,660	20
08732.013	Ø110 x 45°	5,576	20
08732.014	Ø110 x 67 <sup>1</sup> / <sub>2</sub> °	5,914	20
08732.015	Ø110 x 87 <sup>1</sup> / <sub>2</sub> °	5,660	20

**A RICHIESTA ALTRE MISURE**

10

art. **8733**  
Braga in P.P.H.T.



08733.013	Ø32 x 32 x 45°	3,548	30
08733.015	Ø32 x 32 x 67 <sup>1</sup> / <sub>2</sub> °	3,802	20
08733.017	Ø32 x 32 x 87 <sup>1</sup> / <sub>2</sub> °	3,633	20
08733.001	Ø40 x 40 x 45°	2,703	20
08733.002	Ø40 x 40 x 67 <sup>1</sup> / <sub>2</sub> °	3,548	20
08733.003	Ø40 x 40 x 87 <sup>1</sup> / <sub>2</sub> °	2,703	20
08733.021	Ø50 x 50 x 45°	3,464	20
08733.022	Ø50 x 50 x 67 <sup>1</sup> / <sub>2</sub> °	6,590	20
08733.023	Ø50 x 50 x 87 <sup>1</sup> / <sub>2</sub> °	3,464	20
08733.010	Ø90 x 90 x 87 <sup>1</sup> / <sub>2</sub> °	9,124	10
08733.004	Ø90 x 40 x 45°	7,012	20
08733.005	Ø90 x 90 x 45°	9,124	20
08733.006	Ø110 x 40 x 45°	6,843	20
08733.007	Ø110 x 90 x 45°	18,586	20
08733.008	Ø110 x 110 x 45°	9,124	20
08733.009	Ø110 x 110 x 67 <sup>1</sup> / <sub>2</sub> °	11,321	10
08733.011	Ø110 x 40 x 87 <sup>1</sup> / <sub>2</sub> °	6,843	10
08733.012	Ø110 x 90 x 87 <sup>1</sup> / <sub>2</sub> °	18,586	10

**A RICHIESTA ALTRE MISURE**

art. **8734**  
Raccordo curvo in P.P.H.T.

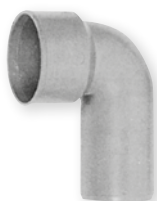

08734.004	Ø32 x 46	2,450	20
08734.001	Ø40 x 46	1,267	20
08734.002	Ø40 x 40	2,602	20
08734.003	Ø40 x 50	1,267	20
08734.021	Ø50 x 50	1,943	20

**A RICHIESTA ALTRE MISURE**

art. **8735**  
Manicotto scorrevole in P.P.H.T.



08735.003	Ø32	2,957	10
08735.001	Ø40	2,061	10
08735.021	Ø50	2,957	10
08735.004	Ø90	7,096	10
08735.002	Ø110	6,167	10

**A RICHIESTA ALTRE MISURE**



**art. 8736**

Tappo in P.P.H.T.

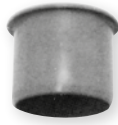

cod. art.	mis.	€	conf.
08736.004	Ø32	<b>2,112</b>	40
08736.001	Ø40	<b>1,014</b>	20
08736.021	Ø50	<b>1,318</b>	20
08736.002	Ø90	<b>3,548</b>	20
08736.003	Ø110	<b>3,464</b>	20

**A RICHIESTA ALTRE MISURE**
**art. 8737**

Aumento in P.P.H.T.



08737.001	Ø32 / 40	<b>2,281</b>	30
08737.002	Ø40 / 50	<b>1,470</b>	20
08737.003	Ø40 / 90	<b>5,322</b>	20
08737.005	Ø90 / 110	<b>6,590</b>	30

**A RICHIESTA ALTRE MISURE**
**art. 8738**

 Riduzione speciale eccentrica  
in P.P.H.T.

08738.001	Ø40 / 32	<b>3,269</b>	25
08738.002	Ø50 / 40	<b>3,041</b>	20

**A RICHIESTA ALTRE MISURE**
**art. 8742**

Curva tecnica prolungata



08742.001	Ø40/46	<b>1,605</b>	20
08742.002	Ø40/50	<b>1,605</b>	20

**art. 8741**

Raccordo tecnico diritto senza morsetto



08741.001	Ø32/46	<b>2,788</b>	20
08741.002	Ø40/46	<b>1,048</b>	20

**A RICHIESTA ALTRE MISURE**
**art. 8739**

Bicchiere 3 lunghezze



08739.001	Ø40	<b>5,576</b>	20
08739.002	Ø50	<b>7,434</b>	20
08739.003	Ø110	<b>11,827</b>	20

**A RICHIESTA ALTRE MISURE**

**art. 8740**

Aumento corto.



cod. art.	mis.	€	conf.
08740.001	Ø32/40	2,703	20
08740.002	Ø40/50	2,788	20
08740.003	Ø40/90	5,576	20
08740.004	Ø40/110	4,765	20
08740.005	Ø50/110	4,393	20
08740.006	Ø90/110	6,421	20

**A RICHIESTA ALTRE MISURE****art. 8743**

Curva ridotta 90°.



08743.000	Ø40/46	2,534	20
-----------	--------	-------	----

**art. 8744**

Tappo protezione per raccordi dritti e curve tecniche.



08744.000	Ø40/46/50	0,980	50
-----------	-----------	-------	----

10

## Raccordi attacchi rapidi e articoli per irrigazione

**art. 1180G**Raccordo porta gomma in ottone giallo.  
Attacco rapido.

1180G.001	1/2"x 14/15 mm	6,240	10
1180G.002	5/8"x 17/18 mm	6,595	10
1180G.003	3/4"x 19/20 mm	6,774	10
1180G.004	7/8"x 23/25 mm	8,199	10
1180G.005	1"x 25/27 mm	8,379	10
1180G.006	1"1/4x 32/35 mm	11,405	10

**art. 1181G**Raccordo Femmina in ottone giallo.  
Attacco rapido.

1181G.001	1/2"	6,415	10
1181G.002	3/4"	6,595	10
1181G.003	1"	6,953	10
1181G.004	1"1/4	10,517	10

**art. 1182G**Raccordo Maschio in ottone giallo.  
Attacco rapido.

1182G.001	1/2"	5,707	10
1182G.002	3/4"	6,415	10
1182G.003	1"	6,953	10
1182G.004	1"1/4	7,841	10

**art. 1183G**Tappo in ottone giallo.  
Attacco rapido.

1183G.000		5,882	10
-----------	--	-------	----

**art. 1184G**

Guarnizione per attacco rapido.



cod. art.	mis.	€	conf.
<b>1184G.000</b>		<b>0,629</b>	100

**art. 1185G**

Lancia corta in ottone giallo.



<b>1185G.001</b>	Ø20 mm	<b>7,666</b>	10
<b>1185G.002</b>	Ø25 mm	<b>11,051</b>	10

**art. 1186G**

Raccordo 3 vie con valvole (2) a sfera in ottone giallo.



<b>1186G.000</b>	3/4"	<b>26,733</b>	10
------------------	------	---------------	----

**art. 1187G**

Raccordo 3 vie F.M.M. in ottone giallo.



<b>1187G.000</b>	3/4"	<b>7,307</b>	10
------------------	------	--------------	----

